



GP38-2

20-2253-1

20-2254-1

20-2255-1

20-2256-1



GL041901

REV.050901

GP38-2 Diesel Engine

Body Parts

Name and Number	Part #	\$Price Per Unit	Name and Number	Part #	\$Price Per Unit
1.) Lens (clear) (headlight / back-up light)	FA-0000019	3.00	8.) Sand fill cap (silver) (SF)(# 2375)(# 2377)(# 2380)	FC-2100675	1.00
2.) Bulbs (clear)(2)(6v) (40.0mm long wires w/ green 2 pin male plug) (grain of wheat)(back-up light)	CF-0000013	3.00	Sand fill cap (maroon) (DM&IR)(# 201)(# 205)(# 208)	FC-2100676	1.00
3.) Handrail (silver) (front & rear)(SF)(# 2375)(# 2377)(# 2380)	FC-2150021	8.00	Sand fill cap (dark blue) (FEC)(# 447)(# 422)(# 428)	FC-2100677	1.00
Handrail (maroon & yellow) (front & rear)(DM&IR)(# 201)(# 205)(# 208)	FC-2150022	8.00	Sand fill cap (blue) (D&H)(# 7325)(# 7315)(# 7319)	FC-2100678	1.00
Handrail (blue & yellow) (front & rear)(FEC)(# 447)(# 422)(# 428)	FC-2150023	8.00	9.) Number board (left rear/right front)(SF)(# 2375)	FG-2100108	2.00
Handrail (yellow & gray) (front & rear)(D&H)(# 7325)(# 7315)(# 7319)	FC-2150024	8.00	Number board (left rear/right front)(SF)(# 2377)	FG-2100109	2.00
4.) Handrail (silver) (9.6mm long)(SF)(# 2375)(# 2377)(# 2380)	FC-2100643	2.00	Number board (left rear/right front)(SF)(# 2380)	FG-2100110	2.00
Handrail (maroon) (9.6mm long)(DM&IR)(# 201)(# 205)(# 208)	FC-2100644	2.00	Number board (left rear/right front)(DM&IR)(# 201)	FG-2100111	2.00
Handrail (yellow) (9.6mm long)(FEC)(# 447)(# 422)(# 428)	FC-2100655	2.00	Number board (left rear/right front)(DM&IR)(# 205)	FG-2100112	2.00
Handrail (gray) (9.6mm long)(D&H)(# 7325)(# 7315)(# 7319)	FC-2100656	2.00	Number board (left rear/right front)(DM&IR)(# 208)	FG-2100113	2.00
Handrail (blue) (9.6mm long)(D&H)(# 7325)(# 7315)(# 7319)	FC-2100657	2.00	Number board (left rear/right front)(FEC)(# 447)	FG-2100114	2.00
5.) Lift ring (silver) (SF)(# 2375)(# 2377)(# 2380)	FC-2100658	0.50	Number board (left rear/right front)(FEC)(# 422)	FG-2100115	2.00
Lift ring (maroon) (DM&IR)(# 201)(# 205)(# 208)	FC-2100659	0.50	Number board (left rear/right front)(FEC)(# 428)	FG-2100116	2.00
Lift ring (dark blue) (FEC)(# 447)(# 422)(# 428)	FC-2100660	0.50	Number board (left rear/right front)(D&H)(# 7325)	FG-2100117	2.00
Lift ring (gray) (D&H)(# 7325)(# 7315)(# 7319)	FC-2100661	0.50	Number board (left rear/right front)(D&H)(# 7315)	FG-2100118	2.00
6.) Side grill (silver)(long) (SF)(# 2375)(# 2377)(# 2380)	FC-2150025	5.00	Number board (left rear/right front)(D&H)(# 7319)	FG-2100119	2.00
Side grill (maroon)(long) (DM&IR)(# 201)(# 205)(# 208)	FC-2150026	5.00	10.) Number board (right rear/left front)(SF)(# 2375)	FG-2100120	2.00
Side grill (dark blue)(long) (FEC)(# 447)(# 422)(# 428)	FC-2150027	5.00	Number board (right rear/left front)(SF)(# 2377)	FG-2100121	2.00
Side grill (blue)(long) (D&H)(# 7325)(# 7315)(# 7319)	FC-2150028	5.00	Number board (right rear/left front)(SF)(# 2380)	FG-2100122	2.00
7.) Shell (silver, red, yellow) (SF)(# 2375)	FC-2100662	*100.00	Number board (right rear/left front)(DM&IR)(# 201)	FG-2100123	2.00
Shell (silver, red, yellow) (SF)(# 2377)	FC-2100663	*100.00	Number board (right rear/left front)(DM&IR)(# 205)	FG-2100124	2.00
Shell (silver, red, yellow) (SF)(# 2380)	FC-2100664	*100.00	Number board (right rear/left front)(DM&IR)(# 208)	FG-2100125	2.00
Shell (maroon, yellow) (DM&IR)(# 201)	FC-2100665	*100.00	Number board (right rear/left front)(FEC)(# 447)	FG-2100126	2.00
Shell (maroon, yellow) (DM&IR)(# 205)	FC-2100667	*100.00	Number board (right rear/left front)(FEC)(# 422)	FG-2100127	2.00
Shell (maroon, yellow) (DM&IR)(# 208)	FC-2100668	*100.00	Number board (right rear/left front)(FEC)(# 428)	FG-2100128	2.00
Shell (blue, white, red) (FEC)(# 447)	FC-2100669	*100.00	Number board (right rear/left front)(D&H)(# 7325)	FG-2100129	2.00
Shell (blue, white, red) (FEC)(# 422)	FC-2100670	*100.00	Number board (right rear/left front)(D&H)(# 7315)	FG-2100130	2.00
Shell (blue, white, red) (FEC)(# 428)	FC-2100671	*100.00	Number board (right rear/left front)(D&H)(# 7319)	FG-2100131	2.00
Shell (gray, yellow, blue) (D&H)(# 7325)	FC-2100672	*100.00	11.) Handrail (silver) (25.7mm across)(SF)(# 2375)(# 2377)(# 2380)	FC-2100679	2.00
Shell (gray, yellow, blue) (D&H)(# 7315)	FC-2100673	*100.00	Handrail (maroon) (25.7mm across)(DM&IR)(# 201)(# 205)(# 208)	FC-2100680	2.00
Shell (gray, yellow, blue) (D&H)(# 7319)	FC-2100674	*100.00			

*Requires Exchange
All parts are priced as each



GP38-2 Diesel Engine

Body Parts

Name and Number	Part #	\$Price Per Unit	Name and Number	Part #	\$Price Per Unit
11.) Handrail (dark blue) (25.7mm across)(FEC)(# 447)(# 422)(# 428)	FC-2100681	2.00	22.) Air horns (3 chime)(blue) (D&H)(# 7325)(# 7315)(# 7319)	FC-2100699	5.00
Handrail (blue) (25.7mm across)(D&H)(# 7325)(# 7315)(# 7319)	FC-2100682	2.00	23.) Side grill (silver)(short) (SF)(# 2375)(# 2377)(# 2380)	FC-2150029	5.00
12.) Fan shroud & grill (silver) (SF)(# 2375)(# 2377)(# 2380)	FC-2100683	3.00	Side grill (maroon)(short) (DM&IR)(# 201)(# 205)(# 208)	FC-2150030	5.00
Fan shroud & grill (maroon) (DM&IR)(# 201)(# 205)(# 208)	FC-2100684	3.00	Side grill (dark blue)(short) (FEC)(# 447)(# 422)(# 428)	FC-2150031	5.00
Fan shroud & grill (dark blue)(FEC)(# 447)(# 422)(# 428)	FC-2100685	3.00	Side grill (blue)(short) (D&H)(# 7325)(# 7315)(# 7319)	FC-2150032	5.00
Fan shroud & grill (blue) (D&H)(# 7325)(# 7315)(# 7319)	FC-2100686	3.00	24.) Handrail (red) (9.6mm long)(SF)(# 2375)(# 2377)(# 2380)	FC-2100700	2.00
13.) Fan shroud & grill (silver) (SF)(# 2375)(# 2377)(# 2380)	FC-2100687	3.00	Handrail (maroon) (9.6mm long)(DM&IR)(# 201)(# 205)(# 208)	FC-2100644	2.00
Fan shroud & grill (maroon) (DM&IR)(# 201)(# 205)(# 208)	FC-2100688	3.00	Handrail (white) (9.6mm long)(FEC)(# 447)(# 422)(# 428)	FC-2100701	2.00
Fan shroud & grill (dark blue)(FEC)(# 447)(# 422)(# 428)	FC-2100689	3.00	Handrail (blue) (9.6mm long)(D&H)(# 7325)(# 7315)(# 7319)	FC-2100657	2.00
Fan shroud & grill (blue) (D&H)(# 7325)(# 7315)(# 7319)	FC-2100690	3.00	25.) Sand fill cap (red) (SF)(# 2375)(# 2377)(# 2380)	FC-2100702	1.00
14.) Fan (light gray)(large)	FC-2100231	2.00	Sand fill cap (maroon) (DM&IR)(# 201)(# 205)(# 208)	FC-2100676	1.00
15.) Pin (black)(for fan) (2.0x4.3mm)(1.4x1.2mm shank)(0.8x3.4mm flathead)	FC-2100691	1.00	Sand fill cap (dark blue) (FEC)(# 447)(# 422)(# 428)	FC-2100677	1.00
16.) Lift ring (silver) (SF)(# 2375)(# 2377)(# 2380)	FC-2100658	0.50	Sand fill cap (blue) (D&H)(# 7325)(# 7315)(# 7319)	FC-2100678	1.00
Lift ring (maroon) (DM&IR)(# 201)(# 205)(# 208)	FC-2100659	0.50	26.) Side mirror (red) (SF)(# 2375)(# 2377)(# 2380)	FC-2100703	2.00
Lift ring (dark blue) (FEC)(# 447)(# 422)(# 428)	FC-2100660	0.50	Side mirror (maroon) (DM&IR)(# 201)(# 205)(# 208)	FC-2100704	2.00
Lift ring (blue) (D&H)(# 7325)(# 7315)(# 7319)	FC-2100692	0.50	Side mirror (dark blue) (FEC)(# 447)(# 422)(# 428)	FC-2100705	2.00
17.) Handrail (silver) (right)(SF)(# 2375)(# 2377)(# 2380)	FC-2110038	12.00	Side mirror (blue) (D&H)(# 7325)(# 7315)(# 7319)	FC-2100706	2.00
Handrail (maroon & yellow) (right)(DM&IR)(# 201)(# 205)(# 208)	FC-2110039	12.00	27.) Builder's plate (GM) (3.1x10.1mm)(gold w/ black background)	FC-2100707	3.00
Handrail (blue & yellow) (right)(FEC)(# 447)(# 422)(# 428)	FC-2110040	12.00	28.) Handrail (red) (9.6mm long)(SF)(# 2375)(# 2377)(# 2380)	FC-2100700	2.00
Handrail (yellow & gray) (right)(D&H)(# 7325)(# 7315)(# 7319)	FC-2110041	12.00	Handrail (maroon) (9.6mm long)(DM&IR)(# 201)(# 205)(# 208)	FC-2100644	2.00
18.) Handrail (silver) (left)(SF)(# 2375)(# 2377)(# 2380)	FC-2120039	12.00	Handrail (white) (9.6mm long)(FEC)(# 447)(# 422)(# 428)	FC-2100701	2.00
Handrail (maroon & yellow) (left)(DM&IR)(# 201)(# 205)(# 208)	FC-2120040	12.00	Handrail (gray) (9.6mm long)(D&H)(# 7325)(# 7315)(# 7319)	FC-2100656	2.00
Handrail (blue & yellow) (left)(FEC)(# 447)(# 422)(# 428)	FC-2120041	12.00	29.) Handrail (red) (9.6mm long)(SF)(# 2375)(# 2377)(# 2380)	FC-2100700	2.00
Handrail (yellow & gray) (left)(D&H)(# 7325)(# 7315)(# 7319)	FC-2120042	12.00	Handrail (maroon) (9.6mm long)(DM&IR)(# 201)(# 205)(# 208)	FC-2100644	2.00
19.) Lens (clear)(side window)	FA-0000020	2.00	Handrail (white) (9.6mm long)(FEC)(# 447)(# 422)(# 428)	FC-2100701	2.00
20.) Antenna (red) (SF)(# 2375)(# 2377)(# 2380)	FC-2100693	2.00	Handrail (yellow) (9.6mm long)(FEC)(# 447)(# 422)(# 428)	FC-2100655	2.00
Antenna (maroon) (DM&IR)(# 201)(# 205)(# 208)	FC-2100694	2.00	Handrail (gray) (9.6mm long)(D&H)(# 7325)(# 7315)(# 7319)	FC-2100656	2.00
Antenna (black) (FEC)(# 447)(# 422)(# 428)	FC-2100695	2.00	30.) Wire strap (white)(metal)	IH-0000103	1.00
Antenna (blue) (D&H)(# 7325)(# 7315)(# 7319)	FC-2100696	2.00	31.) Engineer (black man)	FI-0000030	5.00
21.) Windshield wipers (black)	FC-2100458	1.00	Engineer (white man)	FI-0000001	5.00
22.) Air horns (3 chime)(silver) (SF)(# 2375)(# 2377)(# 2380)	FC-2100697	5.00	32.) Fireman/Brakeman/Conductor (white man)	FI-0000009	5.00
Air horns (3 chime)(maroon) (DM&IR)(# 201)(# 205)(# 208)	FC-2100698	5.00	Fireman/Brakeman/Conductor (black man)	FI-0000033	5.00
Air horns (3 chime)(black) (FEC)(# 447)(# 422)(# 428)	FC-2100253	5.00			

*Requires Exchange
All parts are priced as each



GP38-2 Diesel Engine

Body Parts

Name and Number	Part #	\$Price Per Unit
33.) Engineer base (gray)(right side)	FI-0000025	1.00
34.) Brakeman base (gray)(left side)	FI-0000024	1.00
35.) Gasket (black)(foam) (14.0x22.0mm)(3.0mm thick)	IB-0000010	1.00
36.) Smoke unit funnel (black) (top section)(plastic)	AA-0000035	3.00
37.) Smoke unit funnel (black) (bottom section)(plastic)	AA-0000036	3.00
38.) Screw (M3x8.0mm)(roundhead)(self-drilling)	IA-0000072	0.15
39.) Window lens (clear)(left/left rear)	FA-2100010	4.00
40.) Window lens (clear) (front and right)	FA-2100011	6.00
41.) L.E.D.'s (green)(6v)(2) (60.0mm long wires w/ yellow 2 pin male plug)	CC-0000034	4.00
42.) Bulbs (clear)(6v)(2) (60.0mm long wires w/ blue 2 pin male plug) (grain of wheat)(headlight)	CA-0000044	3.00
43.) Contact spring base (black)(plastic)	BH-0000001	2.00
44.) Contact spring (copper)	IE-0000015	0.50
45.) Bulbs (clear)(6v)(2) (60.0mm long wires w/ white 2 pin male plug) (grain of wheat)(back-up light)	CC-0000035	3.00
46.) L.E.D.'s (red)(6v)(2) (60.0mm long wires w/ yellow 2 pin male plug)	CC-0000036	4.00
47.) Bracket (white) (number board lights)(rear)(plastic)	IH-0000046	2.00
48.) Grommet (black) (cupped)(rubber)	IH-0000144	0.50
49.) Window lens (clear) (door)(4.4x12.7x1.7mmt)	FA-2100014	2.00

*Requires Exchange
All parts are priced as each



GP38-2 Diesel Engine Body Parts

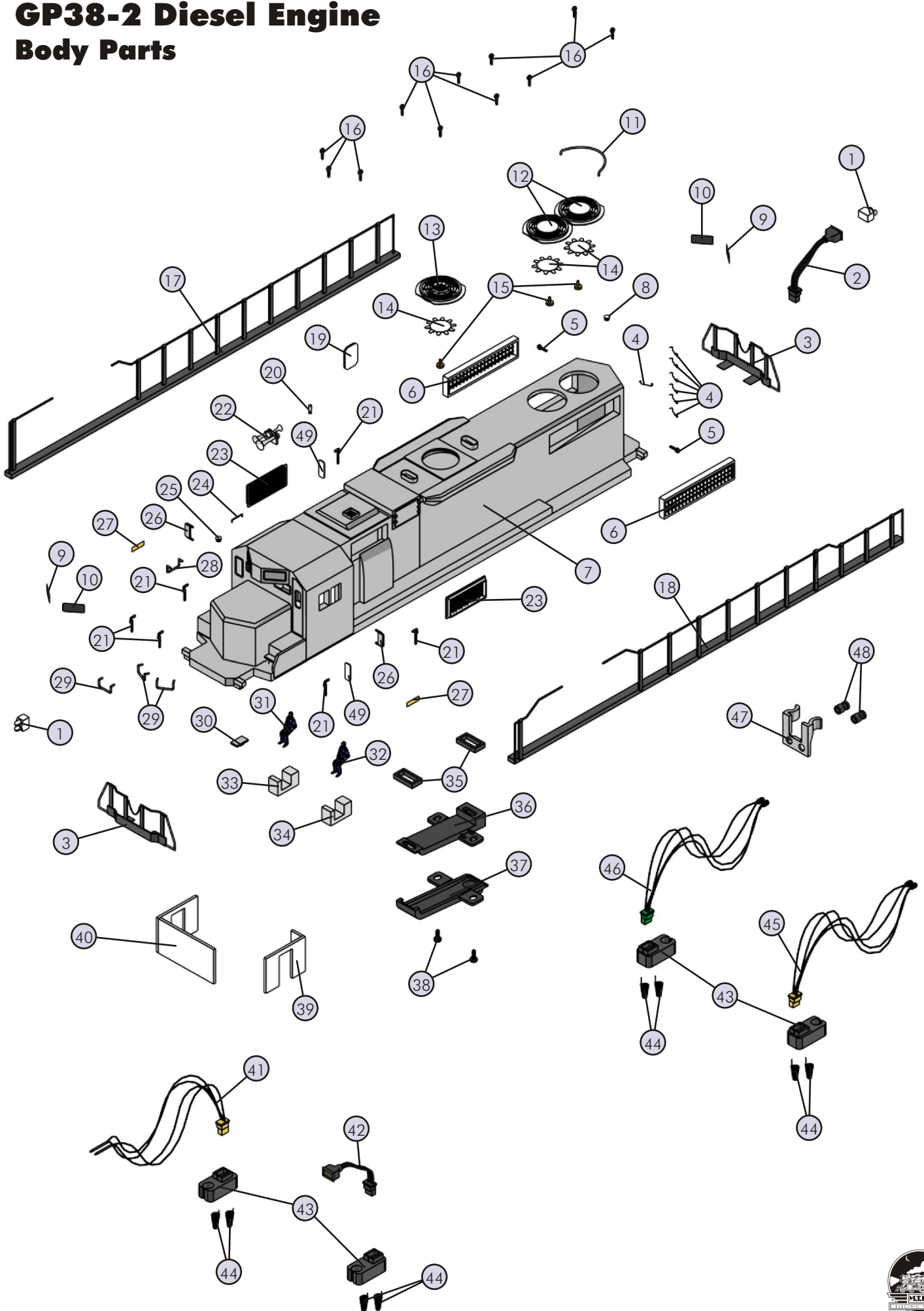

GP38-2 Diesel Engine

Chassis Parts

Name and Number	Part #	\$Price Per Unit	Name and Number	Part #	\$Price Per Unit
1.) Tach board (green)	AG-0000033	6.00	34.) Bulbs (clear)(6v)(2)	CG-0000034	3.00
2.) Rubber band	BI-4500004	0.50	(100.0mm long wires w/ red 2 pin male plug)		
3.) Motor (RS-385PH)	BE-0000088	25.00	(grain of wheat)(cab interior)		
(w/ 7.8x16.5mm worm gear)(12.5mm long threads)			35.) Bulbs (clear)(6v)(2)	CC-0000037	3.00
(9.0x30.0mm black flywheel)			(100.0mm long wires w/ white 2 pin male plug)		
(has black bracket for tach board)			(grain of wheat)(number boards light)		
4.) Motor (RS-385PH)	BE-0000089	25.00	36.) Motor cover (gray)	BI-0000010	7.00
(w/ 7.8x16.5mm worm gear)(12.5mm long threads)			37.) Chassis (black)(57.0x350.0mm)	DH-2100027	*15.00
(9.0x30.0mm black flywheel)			38.) Screw	IA-0000025	0.15
5.) Tach tape	BE-0000069	1.00	(M3x16.0mm)(washer head)(self-drilling)		
(1.96mm wide stripes)(for 30.0mm flywheel)			39.) Screw	IA-0000055	0.15
6.) Motor mount (black)	BI-0000009	15.00	(M2.5x4.0mm)(flathead)		
(fits 2 axle Premier diesel trucks)			40.) Bell (black)	FC-2100263	2.00
7.) Screw (yellow Zink)	IA-0000001	0.15	(DM&IR)(# 201)(# 205)(# 208)		
(M2.5x6.0mm)(roundhead)(w/ lock washer)			(FEC)(# 447)(# 422)(# 428)		
8.) Screw	IA-0000012	0.15	Bell (silver)	FC-2100708	2.00
(M3x14.0mm)(roundhead)(w/ lock washer)			(SF)(# 2375)(# 2377)(# 2380)		
9.) Screw	IA-0000296	0.15	(D&H)(# 7325)(# 7315)(# 7319)		
(M3x3.0mm)(roundhead)			41.) Bracket (speaker)	IH-0000011	1.00
10.) Contact spring board	BH-0000008	2.00	(9.5x12.0x5.0mm)(rounded corner by mounting end)		
(12.0x35.5mm)			42.) Speaker (STAR)(PR-050-A111)	BF-0000007	8.95
11.) Wire nut (yellow)	BI-4500003	0.25	(16 ohms)(MAX 2W)(121E)		
12.) Screw	IA-0000035	0.15	43.) Fuel tank (black)	FC-2100709	*15.00
(M3x8.0mm)(roundhead)			(DM&IR)(# 201)(# 205)(# 208)		
13.) Volume pot	BI-0000040	5.00	(FEC)(# 447)(# 422)(# 428)		
(small volume pot)(blue w/ green board)			Fuel tank (silver)	FC-2100710	*15.00
14.) Spacer (black)	ID-0000071	0.15	(SF)(# 2375)(# 2377)(# 2380)		
(3.0x6.0x4.3mm)(plastic)			(D&H)(# 7325)(# 7315)(# 7319)		
15.) Screw	IA-0000016	0.15	44.) Screw	IA-0000038	0.15
(M3x6.0mm)(roundhead)			(4/40x6.0mm)(flathead)		
16.) Bracket (Aluminum)	IH-0000198	3.00	45.) Wire strap (black)	IH-0000012	1.00
(for Proto-Sound 2.0® boards)(tapped for 6/32 screw)			(metal)(small)		
(15.0x43.5mm)(10.5mm step-up)			46.) Pilot (silver)	DG-2150025	15.00
17.) Screw	IA-0000103	0.15	(pilot has 2 screw holes for mounting pilot)		
(6/32x12.0mm)(roundhead)			(SF)(# 2375)(# 2377)(# 2380)		
18.) Screw	IA-0000058	0.15	Pilot (maroon, black, yellow)	DG-2150026	15.00
(M2x4.0mm)(roundhead)			(pilot has 2 screw holes for mounting pilot)		
19.) Switch (small)	BB-0000009	5.00	(DM&IR)(# 201)(# 205)(# 208)		
20.) Insulator (clear)	ID-0000024	0.15	Pilot (black, red, white, yellow)	DG-2150027	15.00
(13.0x19.0x0.1mm)(single hole)			(pilot has 2 screw holes for mounting pilot)		
21.) Voltage regulator	AG-0000032	3.00	(FEC)(# 447)(# 422)(# 428)		
(LM2937ET)			Pilot (gray)	DG-2150028	15.00
22.) Insulator (white)	ID-0000025	0.15	(pilot has 2 screw holes for mounting pilot)		
(washer)(3.0x6.0x3.0mm)(plastic)			(D&H)(# 7325)(# 7315)(# 7319)		
23.) Boards (Proto-Sound 2.0®)	AE-0000001	*200.00	47.) Air hoses (black)(3 lines)	FC-2100711	3.00
24.) Screw	IA-0000003	0.15	48.) Truck side (black)	DB-2060010	7.00
(4/40x6.0mm)(roundhead)			(truck side screws mount from the bottom)		
25.) Smoke unit	AA-0000037	50.00	(DM&IR)(# 201)(# 205)(# 208)		
(for Proto-Sound 2.0®)(12.0x4.0x5.0mm brass cup)			(FEC)(# 447)(# 422)(# 428)		
(26.0mm long mounting posts)			Truck side (silver)	DB-2250003	7.00
26.) Battery leads	BC-0000092	3.00	(truck side screws mount from the bottom)		
(100.0mm long wires w/small 2 pin black male plug)			(SF)(# 2375)(# 2377)(# 2380)		
27.) Battery	BG-4000001	9.95	(D&H)(# 7325)(# 7315)(# 7319)		
28.) Screw	IA-0000010	0.15	49.) Screw (nickel)	IA-0000015	0.15
(M3x4.0mm)(roundhead)			(M3x6.0mm)(roundhead)		
29.) Bracket (black)	IH-0000042	3.00	50.) Insulator (black)	BD-0000015	2.00
(battery)(vertical mount)(plastic)			(top)(square)(pick-up)		
30.) Wire strap (white)(metal)	IH-0000103	1.00	51.) Truck (black)(powered)	DA-2050010	*30.00
31.) Grommet (black)	IH-0000010	0.15	(2 axle)(2 screw holes for 2 screw mount pilot)		
(4.5x5.0mm)(rubber)			52.) T-bar	IG-0000001	0.50
32.) Screw	IA-0000005	0.15			
(M2.5x4.0mm)(roundhead)					
33.) Bracket	IH-0000045	3.00			
(interior light / # boards)					

*Requires Exchange
All parts are priced as each



GP38-2 Diesel Engine

Chassis Parts

Name and Number	Part #	\$Price Per Unit
53.) Proto-Coupler 2.0® (51.0mm long)	DD-0000032	10.00
54.) Spring (nickel) (6.5x11.0mm)(w/ 0.4mm thick wire)	IE-0000007	0.50
55.) Washer (5.0x10.0x1.0mm)	ID-0000026	0.15
56.) E-clip (3.0x8.0x0.5mm)	IF-0000002	0.15
57.) Pick-up (8.0x11.0mm roller)(28.0mm long)	BD-0000025	5.00
58.) Insulator (black)(pick-up) (bottom)(flat w/ rect. box)(18.0x30.0mm)	BD-0000039	2.00
59.) Nut (nickel) (2.5x5.0x10.0mm)	IC-0000005	0.50
60.) Traction Tire	DE-0000018	0.75
61.) Snow plow (silver) (SF)(# 2375)(# 2377)(# 2380)	FH-2130012	3.00
Snow plow (black) (DM&IR)(# 201)(# 205)(# 208) (FEC)(# 447)(# 422)(# 428)	FH-2130001	3.00
Snow plow (gray) (D&H)(# 7325)(# 7315)(# 7319)	FH-2130006	3.00
NS.) Wire harness (12 pin male plug)	BC-2100001	15.00
NS.) Wire harness (7 pin male plug)	BC-2100002	10.00
NS.) Wire harness (5 pin male plug)	BC-2100003	4.00
NS.) Wire harness (4 pin male plug)	BC-2100004	4.00

*Requires Exchange
All parts are priced as each



GP38-2 Diesel Engine Chassis Parts

