

RAILKING[®]
By M.T.H. Electric Trains

30-2150-1
30-2151-1

PA AA Set



GL071701



PA A Unit (lead) Diesel Engine

Engine Parts

Name and Number	Part #	\$Price Per Unit	Name and Number	Part #	\$Price Per Unit
1.) Diaphragm	FI-0000017	2.00	32.) Washer (7.0x12.0x0.5mm)	ID-0000034	0.15
2.) Lens (clear)(portal/headlight)	FA-0000092	2.00	33.) Bracket (volume pot)	IH-0000023	2.00
3.) Air horns (nickel)(2 chime)	FC-2200254	3.00	34.) Volume pot	BI-0000061	5.00
4.) Shell (red, yellow, silver, black) (A unit)(Santa Fe)(# 64)	FC-2200263	*85.00	(B10K SW)(w/ 65.0mm long wires)		
Shell (white, green)	FC-2200264	*85.00	35.) Clip (black)	IF-0000006	1.00
(A unit)(Southern)(# 6902)			(Proto-Sound® board)(top)(plastic)		
5.) Number board (sticker)	FG-2200043	0.50	36.) Clip (black)	IF-0000007	1.00
(black background w/ white letters)(Santa Fe)(# 64)			(Proto-Sound® board)(bottom)(plastic)		
Number board	FG-2200044	0.50	37.) Battery leads	BC-0000038	3.00
(black background w/ white letters)(sticker)			(150.0mm long wires w/ white male 2 pin plug)		
(Southern)(# 6902)			38.) Battery	BG-4000001	10.00
6.) Windows (clear)	FA-2230019	5.00	39.) Bracket (black)	IH-0000042	3.00
7.) Bracket (black)	IH-0000252	3.00	(battery)(vertical mount)(plastic)		
(metal)(12.0x35.5mm)(L-shaped)(for headlight)			40.) Wire harness	BC-2200015	8.00
8.) Screw	IA-0000275	0.15	(black male 4 pin plug)(300.0mm long black wires)		
(4/40x3.0mm)(roundhead)			(345.0mm long yellow wire w/ blue male 4 pin plug)		
9.) Grommet (black)	IH-0000010	0.50	(260.0mm long wires w/ green male 2 pin plug)		
(4.5x5.0mm)(rubber)			41.) T-bar (black)(plastic)	IG-0000001	0.50
10.) Chassis (black)	DH-2200056	*15.00	42.) Coupler (black)	DD-4000005	3.00
(powered A unit)			(non-operating)(34.5mm long)(T-bar mounting)		
11.) Wire nut (yellow)	BI-4500003	0.25	43.) Spring (nickel)	IE-0000022	0.50
12.) Bulbs (clear)(2)(1.5v)	CA-0000052	3.00	(6.5x14.0mm)(w/ 0.5 mm thick wire)		
(220.0mm long blue wires w/ blue male 2 pin plug)			44.) Washer (4.5x10.0x0.6mm)	ID-0000041	0.15
(headlight)			45.) E-clip (3.0x8.0x0.5mm)	IF-0000002	0.15
13.) Screw	IA-0000012	0.15	46.) Wire strap (black)(metal)(small)	IH-0000012	1.00
(M3x14.0mm)(roundhead)(w/ lock washer)			47.) Screw (nickel)	IA-0000015	0.15
14.) Screw (yellow Zinc)	IA-0000001	0.15	(M3x6.0mm)(roundhead)		
(M2.5x6.0mm)(roundhead)(w/ lock washer)			48.) Insulator (black)	BD-0000026	2.00
15.) Motor mount (black)	BI-0000029	15.00	(top)(square)(pick-up)		
(for RK 3 axle truck)			49.) Screw	IA-0000038	0.15
16.) Motor (RS-365SH)	BE-0000094	25.00	(4/40x6.0mm)(flathead)		
(7.9x24.0mm worm gear w/ 13.0mm long threads)			50.) Truck side (black)	DB-2200011	9.00
(9.0x30.0mm black tapered flywheel)			(right rear/left front)(for 3 axle truck)		
17.) Motor (RS-365SH)	BE-0000095	25.00	(Southern)(# 6902)		
(7.9x24.0mm worm gear w/ 13.0mm long threads)			Truck side (silver)	DB-2200013	9.00
(9.0x30.0mm brass tapered flywheel)			(right rear/left front)(for 3 axle truck)		
18.) Rubber band	BI-4500004	0.50	(Santa Fe)(# 64)		
19.) Board	AE-4500001	*100.00	51.) Truck side (black)	DB-2200012	9.00
(Proto-Sound®)(top)			(left rear/right front)(for 3 axle truck)		
20.) Proto-Sound® chip	N/A	19.95	(Southern)(# 6902)		
21.) Board	AD-4500001	*60.00	Truck side (silver)	DB-2200014	9.00
(Proto-Sound®)(bottom)			(left rear/right front)(for 3 axle truck)		
22.) Screw	IA-0000058	0.15	(Santa Fe)(# 64)		
(M2x4.0mm)(roundhead)			52.) Traction tire	DE-0000018	0.75
23.) Switch (large)	BB-0000006	5.00	53.) Truck (powered)(3 axle)	DA-2050009	*35.00
24.) Screw	IA-0000003	0.15	(powered)(3 axle)(single screw pilot mount)		
(4/40x6.0mm)(roundhead)			54.) Nut (nickel)(2.5x5.0x7.0mm)	IC-0000008	0.50
25.) Insulator (white)	ID-0000025	0.15	55.) Insulator (black)	BD-0000006	2.00
(washer)(3.0x6.0x3.0mm)(plastic)			(pick-up)(bottom)(square)(flat)		
26.) Insulator (clear)	ID-0000024	0.15	56.) Pick-up	BD-0000013	5.00
(13.0x19.0x0.1mm)(single hole)			(8.0x11.0mm roller)(24.0mm long)		
27.) Bracket (brass)	IH-0000072	2.00	57.) Screw	IA-0000107	0.15
(Proto-Sound board mounting)			(M3x18.0mm)(washer head)(self-drilling)		
28.) Heat sink (Aluminum)	AI-0000035	2.00	58.) Bracket (black)	IH-0000231	1.00
(3.0x20.0x16.0mm)			(speaker)(10.0x12.0x5.0mm)(1.0mm thick)		
29.) Screw	IA-0000191	0.15	(rounded corner by mounting end)		
(4/40x30.0mm)(roundhead)			59.) Speaker	BF-4500008	8.95
30.) Screw	IA-0000072	0.15	(Star, PR-05004-08)(8 ohms)(0.2 watt)		
(M3x8.0mm)(roundhead)(self-drilling)					
31.) Nut	IC-0000007	0.50			
(6.0x10.0x2.0mm)(for volume pot)					

*Requires Exchange

All parts are priced as each



PA A Unit (lead) Diesel Engine

Engine Parts

Name and Number	Part #	\$Price Per Unit
60.) Fuel tank (black) (has square holes for speaker)(Southern)(# 6902)	FC-2200256	*15.00
Fuel tank (silver) (has square holes for speaker)(Santa Fe)(# 64)	FC-2200262	*15.00
61.) Pilot (black) (single screw hole for mounting pilot) (Southern)(# 6902)	DG-2230013	15.00
Pilot (silver) (single screw hole for mounting pilot) (Santa Fe)(# 64)	DG-2230014	15.00
62.) Proto-Coupler® (black) (44.5mm long)	DD-0000004	10.00

*Requires Exchange
All parts are priced as each

PA A Unit (lead) Diesel Engine Engine Parts

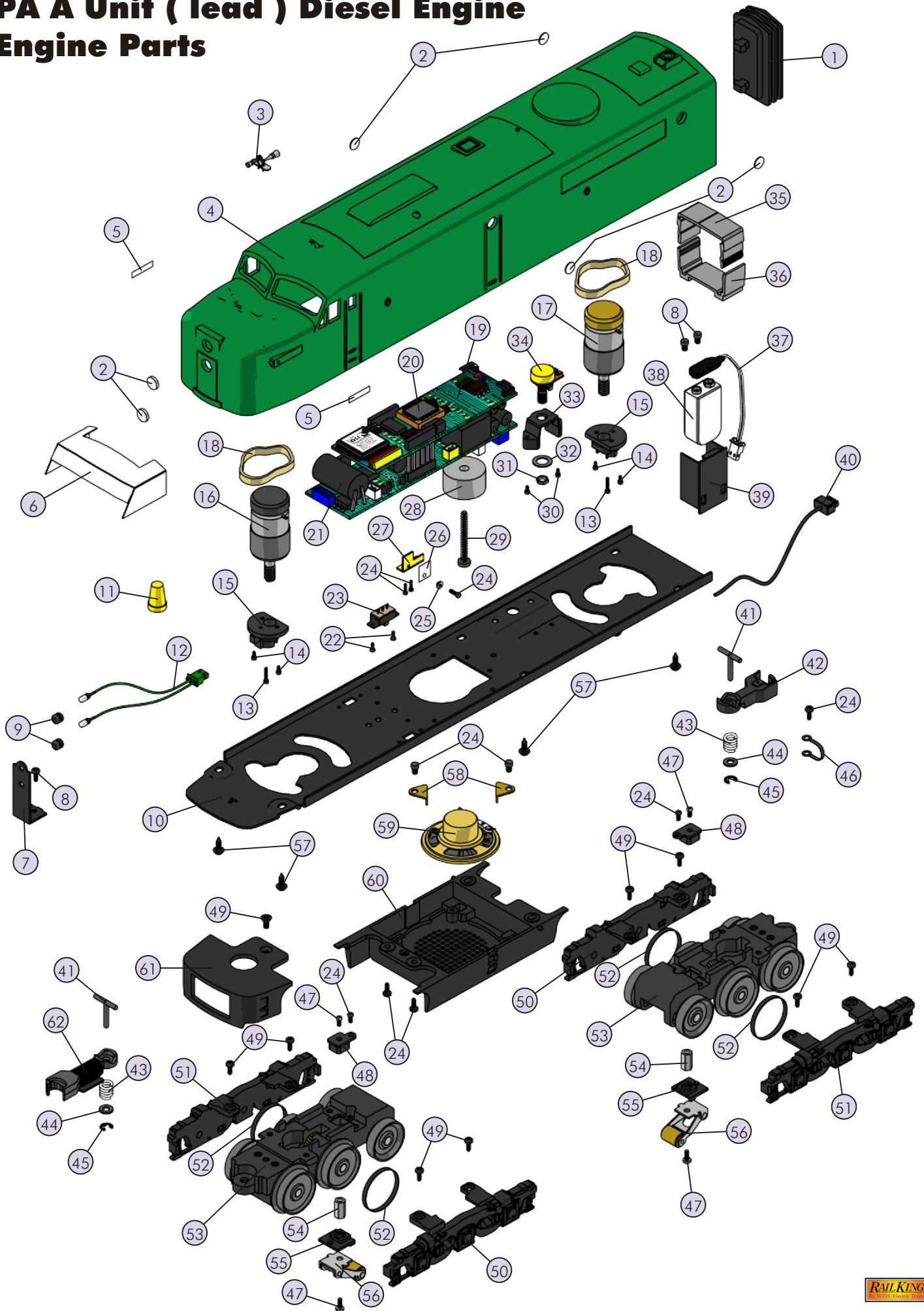

PA A Unit (trailing) Diesel Engine

Engine Parts

Name and Number	Part #	\$Price Per Unit	Name and Number	Part #	\$Price Per Unit
1.) Diaphragm	FI-0000017	2.00	26.) Truck (black)	DA-2000016	*35.00
2.) Lens (clear)(portal/headlight)	FA-0000092	2.00	(non-powered)(3 axle)		
3.) Air horns (nickel)(2 chime)	FC-2200254	3.00	(2 tapped holes under coupler mount for PC board)		
4.) Shell (red, yellow, silver, black)	FC-2200265	*85.00	27.) E-clip (3.0x8.0x0.5mm)	IF-0000002	0.15
(A unit)(Santa Fe)(# 69)			28.) Washer (4.5x10.0x0.6mm)	ID-0000041	0.15
Shell (white, green)	FC-2200266	*85.00	29.) Spring (nickel)	IE-0000022	0.50
(A unit)(Southern)(# 6903)			(6.5x14.0mm)(w/ 0.5 mm thick wire)		
5.) Number board (sticker)	FG-2200045	0.50	30.) Proto-Coupler® (black)	DD-0000004	10.00
(black background w/ white letters)(Santa Fe)(# 69)			(44.5mm long)		
Number board	FG-2200046	0.50	31.) T-bar (black)(plastic)	IG-0000001	0.50
(black background w/ white letters)(sticker)			32.) Pilot (black)	DG-2230013	15.00
(Southern)(# 6903)			(single screw hole for mounting pilot)		
6.) Windows (clear)	FA-2230019	5.00	(Southern)(# 6902)		
7.) Bracket (black)	IH-0000252	3.00	Pilot (silver)	DG-2230014	15.00
(metal)(12.0x35.5mm)(L-shaped)(for headlight)			(single screw hole for mounting pilot)		
8.) Grommet (black)	IH-0000010	0.50	(Santa Fe)(# 64)		
(4.5x5.0mm)(rubber)					
9.) Screw	IA-0000275	0.15			
(4/40x3.0mm)(roundhead)					
10.) Bulbs (clear)(2)(1.5v)	CF-0000021	3.00			
(170.0mm long green wires w/ green male 2 pin plug)					
(rear light)					
11.) Chassis (black)	DH-2200058	*15.00			
(non-powered A unit)					
12.) Bolt (black)	IA-0000088	1.00			
(8/32x15.0mm)(6.0x8.0mm oversized shank)					
(1.8x10.0mm slotted head)					
13.) Spring (nickel)	IE-0000026	0.50			
(8.0x12.0mm)(w/ 0.7 thick wire)					
14.) Wire strap (white)(metal)	IH-0000103	1.00			
15.) Wire harness	BC-2200017	8.00			
(vertical mount 4 pin PC board)(190.0mm long wires)					
(w/ black & green male 2 pin plug)					
16.) Screw	IA-0000058	0.15			
(M2x4.0mm)(roundhead)					
17.) Screw	IA-0000107	0.15			
(M3x18.0mm)(washer head)(self-drilling)					
18.) Coupler (black)	DD-4000008	3.00			
(non-operating)(34.5mm long)(screw base mounting)					
19.) Centering spring (nickel)	IE-0000027	0.50			
20.) Screw	IA-0000108	0.15			
(M2.5x6.0mm)(washer head)					
21.) Screw	IA-0000038	0.15			
(4/40x6.0mm)(flathead)					
22.) Fuel tank (black)	FC-2200256	*15.00			
(has square holes for speaker)(Southern)(# 6902)					
Fuel tank (silver)	FC-2200262	*15.00			
(has square holes for speaker)(Santa Fe)(# 64)					
23.) Screw	IA-0000003	0.15			
(4/40x6.0mm)(roundhead)					
24.) Truck side (black)	DB-2200011	9.00			
(right rear/left front)(for 3 axle truck)					
(Southern)(# 6902)					
Truck side (silver)	DB-2200013	9.00			
(right rear/left front)(for 3 axle truck)					
(Santa Fe)(# 64)					
25.) Truck side (black)	DB-2200012	9.00			
(left rear/right front)(for 3 axle truck)					
(Southern)(# 6902)					
Truck side (silver)	DB-2200014	9.00			
(left rear/right front)(for 3 axle truck)					
(Santa Fe)(# 64)					

*Requires Exchange
All parts are priced as each

PA A Unit (trailing) Diesel Engine Engine Parts

