



Subway Cars

4-Car Set

30-2122-0
30-2122-1
30-2162-0
30-2162-1



Subway Cars

Non-powered Unit Parts

NameandNumber	Part#	PricePerUnit
1.) Shell(NYCTA)(#4825)	FE-4200001	*50.00
1.) Shell(NYCTA)(#4904)	FE-4200002	*50.00
1.) Shell(NYCTA)(#4905)	FE-4200003	*50.00
2.) Door(rear)(silver)	FE-4200004	6.00
3.) Doorframe(rear)(silver)	FE-4200005	8.00
4.) Windowlens(rear)	FA-4200001	4.00
5.) Screw	IA-0000204	0.15
6.) Screw	IA-0000025	0.15
7.) Screw	IA-0000261	0.15
8.) Numberboard(#4825)	FG-4200001	2.00
8.) Numberboard(#4904)	FG-4200002	2.00
8.) Numberboard(#4905)	FG-4200003	2.00
9.) Windowlens(fitsbothsides)	FA-4200002	8.00
10.) Contactspringbase	BH-0000001	2.00
11.) Contactsprings	IE-0000015	0.50
12.) Screw	IA-0000088	1.00
13.) Spring	IE-0000026	0.50
14.) Interioridetail(gray)	FE-4200006	15.00
15.) Screw	IA-0000021	0.15
16.) Contactspringboard	BH-0000020	2.00
17.) Screw	IA-0000203	0.15
18.) Bulbguide(101/4"long)	CH-0000012	8.00
19.) Socket(bulb) (fitspart#CH-0000014)	CH-0000013	1.00
20.) Bulbbase(w/shield) (fitspart#CG-0000015)	CH-0000014	1.00
21.) Bulb(14V)(grainofwheat)	CG-0000015	1.00
22.) Doorframe(front)(silver)	FE-4200007	8.00
23.) Door(front)(silver)	FE-4200008	6.00
24.) Windowlens(front)(E)	FA-4200003	6.00
25.) Lens(red)	FA-4200004	2.00
26.) Lens(clear)	FA-4200005	2.00
27.) Coupler(non-operating) (34.5mmlong)	DD-4000005	3.00
28.) Coupler(mechanical)	DD-0000009	3.00
29.) Couplerarmature	DD-0000010	1.00
30.) Washer	ID-0000009	0.15
31.) E-clip(3.0X8.0X0.5mm)	IF-0000002	0.15
32.) Spring	IE-0000030	0.50
33.) Screw	IA-0000003	0.15
34.) T-bar	IG-0000001	0.50
35.) Truckside(black) (leftrear/rightfront)	DB-4200001	7.00
36.) Truckside(black) (rightrear/leftfront)	DB-4200002	7.00
37.) Undercarriagedetail(black)	FE-4200009	10.00
38.) Truck(non-operating) (Trucksidescrews mount frombottom)	DA-0000001	20.00
39.) Screw	IA-0000015	0.15
40.) Pick-up (8.0X11.0mmroller)(19.5mmlong)	BD-0000042	5.00
41.) Insulator(pick-up)(bottom)	BD-0000006	2.00
42.) Nut(2.5X5.0X7.0mm)	IC-0000008	0.50
43.) Insulator(pick-up)(top)	BD-0000026	2.00
44.) Spring	IE-0000022	0.50
45.) Washer	ID-0000009	0.15
46.) Chassis(non-poweredunit)	DH-4200001	*15.00
47.) Insulatorwasher (clear)(5.0X9.0X0.2mm)	ID-0000031	0.15

* Requires Exchange

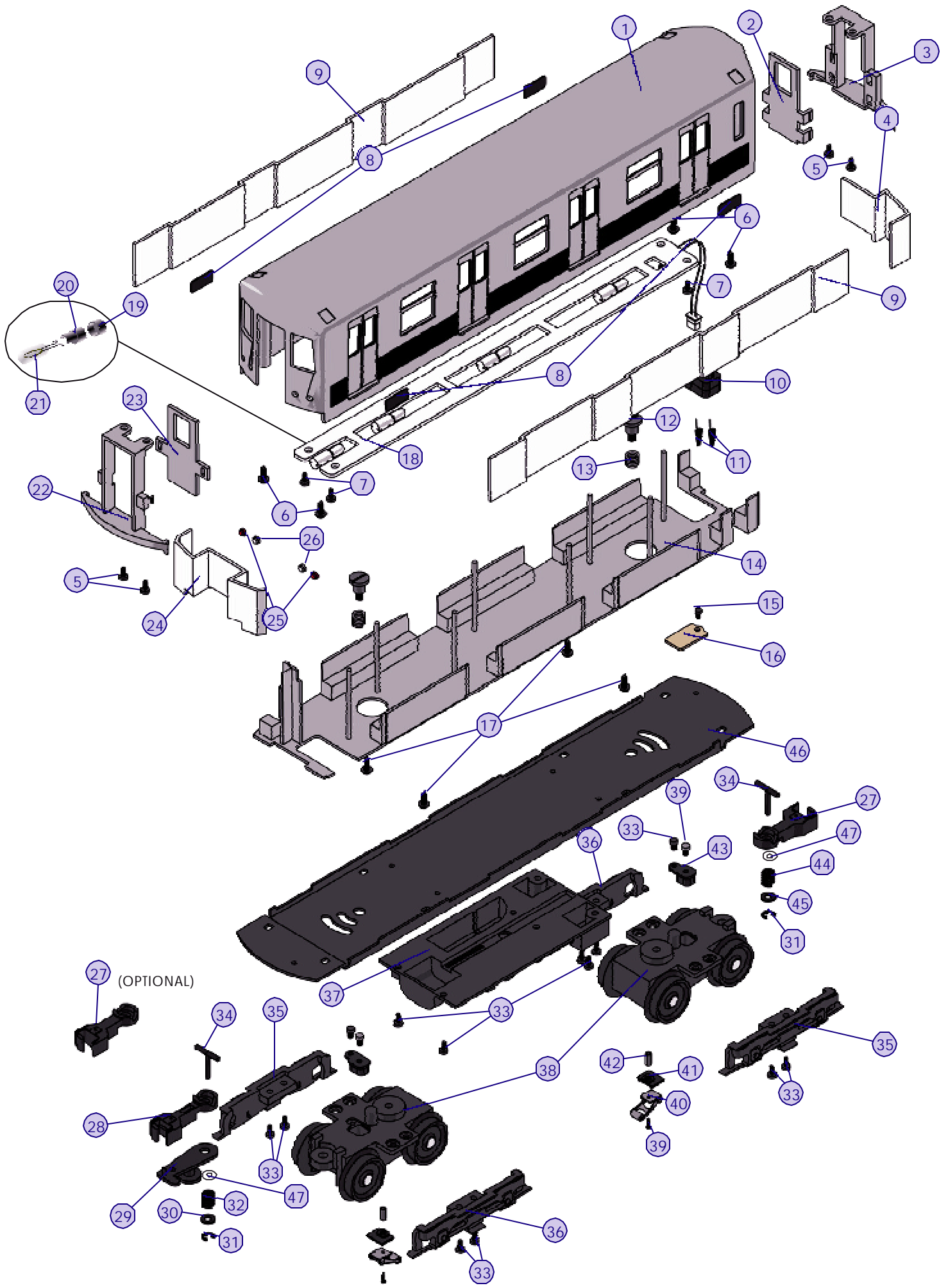

Subway Cars

Powered Unit Parts

NameandNumber	Part#	PricePerUnit
1.) Shell(NYCTA)(#4824)	FE-4200010	*50.00
2.) Windowlens(fitsbothsides)	FA-4200002	8.00
3.) Numberboard(#4824)	FG-4200004	2.00
4.) Doorframe(rear)(silver)	FE-4200005	8.00
5.) Door(rear)(silver)	FE-4200004	6.00
6.) Windowlens(rear)	FA-4200001	4.00
7.) Screw	IA-0000204	0.15
8.) Screw	IA-0000025	0.15
9.) Interiordetail(gray)	FE-4200011	20.00
10.) Door(front)(silver)	FE-4200008	6.00
11.) Doorframe(front)(silver)	FE-4200007	8.00
12.) Windowlens(front)(E)	FA-4200003	6.00
13.) Socket(bulb) (fitspart#CH-0000014)	CH-0000013	1.00
14.) Bulbbase(w/shield) (fitspart#CG-0000015)	CH-0000014	1.00
15.) Bulb(14V)(grainofwheat (interior))	CG-0000015	1.00
16.) Rubbergrommet	IH-0000010	0.15
17.) Bulbs(1.5V)(bluewires) (grainofwheat)(250.0mmlongwires)(headlight)	CA-0000013	3.00
18.) Lens(clear)	FA-4200005	2.00
19.) Lens(red)	FA-4200004	2.00
20.) Proto-sound chip	N/A	*19.95
21.) Proto-soundboard(top)	AE-4500001	*100.00
22.) Proto-soundboard(bottom)	AD-4500001	*60.00
23.) Bracket(Proto-soundboard)	IH-0000080	2.00
24.) Screw	IA-0000003	0.15
25.) Insulator	ID-0000026	1.00
26.) Insulator(washer)	ID-0000033	0.15
27.) Screw	IA-0000021	0.15
28.) Bracket(speaker)	IH-0000044	1.00
29.) Speaker (Unison,U4508BSR,8ohm,0.9W)	BF-4500013	8.95
30.) Nut	IC-0000007	0.50
31.) Washer	ID-0000034	0.15
32.) Screw	IA-0000192	0.15
33.) Heatsink (3.0X16.0X15.0mm)	AI-0000020	2.00
34.) Volumepot (w/140.0mmlongwires)	BI-0000020	5.00
35.) Bracket(volumepot)	IH-0000081	2.00
36.) Screw	IA-0000003	0.15
37.) Screw	IA-0000203	0.15
38.) Batteryleads (w/150.0mmlongwires)	BC-0000002	3.00
39.) Battery	BG-4000001	9.95
40.) Rubberband	BI-4500004	0.50
41.) Motor(RS-365SH) (8.0X20.0mmwormgear)(9.0X30.0mmtaperedflywheel)	BE-0000043	25.00
42.) Motormount	BI-0000033	15.00
43.) Screw	IA-0000089	0.15
44.) Screw	IA-0000012	0.15
45.) Chassis(poweredunit)	DH-4200002	*15.00
46.) T-bar	IG-0000001	0.50
47.) Coupler(non-operating)	DD-4000005	3.00
48.) Spring	IE-0000022	0.50
49.) Washer	ID-0000009	0.15
50.) E-clip	IF-0000002	0.15

NameandNumber	Part#	PricePerUnit
52.) Insulator(pick-up)(top)	BD-0000026	2.00
53.) Truckside(black) (rightrear/leftfront)	DB-4200002	7.00
54.) Truckside(black) (leftrear/rightfront)	DB-4200001	7.00
55.) Nut	IC-0000008	0.50
56.) Insulator(pick-up)(bottom)	BD-0000006	2.00
57.) Pick-up (8.0X11.0mmroller)(19.5mmlong)	BD-0000042	5.00
58.) Truck(powered)(2axle) (trucksidescrawmountfrombottom)	DA-0000002	*30.00
59.) Tractiontires	DE-0000014	0.75
60.) Undercarriagedetail(black)	FE-4200009	10.00
61.) Proto-coupler (44.5mmlong)	DD-0000004	10.00
62.) Bracket (battery)(vertical mount)	IH-0000042	3.00

Horn Only Parts

NameandNumber	Part#	PricePerUnit
17.) Bulbs(1.5V)(bluewires) (grainofwheat)(90.0mmlongwires)	CA-0000014	3.00
N/S) Wireharness(Headlight) (160.0mmlongwires)(bluewiresandplug)	BC-0000023	2.00
21.) Board (horn)	AF-4500004	29.95
22.) Board (DCRU)(w/black,blueandredplugs)	AC-0000004	39.95
32.) Screw	IA-0000026	0.15
33.) Heatsink (3.0X20.0X7.0mm)	AI-0000021	2.00
N/S) Switch(small)	BB-0000009	5.00
N/S) Screw(forswitch)	IA-0000058	0.15
N/S) Coupler(mechanical)	DD-0000009	3.00
N/S) Couplerarmature	DD-0000010	1.00

*REQUIRESEXCHANGE

