

*RAILKING*  
**READY-TO-RUN™**  
THE COMPLETE SOLUTION

[www.railking.com](http://www.railking.com)

# 2-8-0 Steam Freight Set

## Operation Manual



**LocoSound**  
Loco Speed Control

**RAILKING**  
By MTH Electric Trains

Thank you for purchasing this RailKing product.  
PLEASE READ BEFORE USE AND SAVE

# Table of Contents

<b>Set Up Checklist</b> .....	<b>3</b>
<b>Getting Started</b> .....	<b>4</b>
Assembling RealTrax .....	4
Plugging in the Transformer .....	4
Lubricating the Engine .....	5
Priming the Smoke Unit .....	5
Coupling the Engine and Cars .....	5
Remote Control .....	6
<b>Basic Operation</b> .....	<b>7</b>
Operation Buttons .....	7
Speed Control .....	7
Direction Lock .....	8
Proto-Cast and Proto-Dispatch .....	8
Manual Volume Control .....	9
<b>Maintenance</b> .....	<b>10</b>
Care of Remote Control .....	10
Lubrication and Greasing Instructions .....	10
Cleaning the Wheels, Tires and Track .....	11
Locomotive Traction Tire Replacement .....	11
Smoke Unit Maintenance .....	12
Locomotive Light Bulb Replacement .....	13
Caboose Light Bulb Replacement .....	13
<b>RailWare Interactive CD ROM</b> .....	<b>14</b>
<b>Troubleshooting</b> .....	<b>15</b>
<b>Compatibility</b> .....	<b>16</b>
<b>Transformer Compatibility Chart</b> .....	<b>16</b>
<b>Parts</b> .....	<b>17</b>
<b>Service and Warranty Information</b> .....	<b>23</b>

**CAUTION: ELECTRICALLY OPERATED PRODUCT:**

Not recommended for children under 10 years of age. M.T.H. recommends adult supervision with children ages 10 - 16. As with all electric products, precautions should be observed during handling and use to reduce the risk of electric shock.

**WARNING:** When using electrical products, basic safety precautions should be observed, including the following:

Read this manual thoroughly before using this device.

- M.T.H. recommends that all users and persons supervising use examine the hobby transformer and other electronic equipment periodically for conditions that may result in the risk of fire, electric shock, or injury to persons, such as damage to the primary cord, plug blades, housing, output jacks or other parts. In the event such conditions exist, the train set should not be used until properly repaired.
- Do not operate your layout unattended. Obstructed accessories or stalled trains may overheat, resulting in damage to your layout.
- This train set is intended for indoor use. Do not use if water is present. Serious injury or fatality may result.
- Do not operate the hobby transformer with damaged cord, plug, switches, buttons or case.
- The transformer was designed to operate on regular US household current (120 volt, 50-60 Hertz). Do not connect to any other source of power.
- To avoid the risk of electrical shock, do not disassemble the transformer unit. There are no user-serviceable parts inside. If the unit is damaged contact M.T.H. Service for instructions.
- The transformer is equipped with an internal circuit protector. If the circuit protector trips, unplug the power cord from the electrical wall outlet, check your layout for any short circuits. The circuit breaker will reset automatically when the short is removed from the circuit.
- Unplug the transformer from the electrical wall outlet when not in use.
- Do not use this transformer for other than its intended purpose.

**Transformer Ratings:**

Input: 120 VAC, 60 Hz Only, Output: 14 VAC 80W or 18VAC 100W

This product may be protected by one or more of the following patents: 6,019,289; 6,280,278; 6,281,606; 6,291,263; 6,457,681; 6,491,263; 6,604,641; 6,619,594; 6,624,537; 6,655,640. ©2004, M.T.H. Electric Trains, Columbia, MD 21046

# Set Up Checklist

- Assemble RealTrax®
- Connect the transformer
- Lubricate the engine
- Prime the Smoke Unit
- Place the engine and cars on the track and couple them together
- Position remote lock-on lens
- Apply power to run as described in the Basic Operation section of these instructions.

## Set Includes



Steam Engine with Loco-Sound™

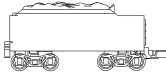

Steam Tender



8-Pieces  
O-31 Curve RealTrax

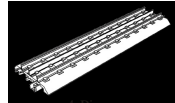

4-Pieces  
10" Straight RealTrax

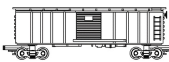

Stock Car

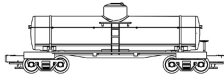

Tank Car or Gondola

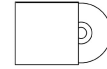

DVD/CD-Rom

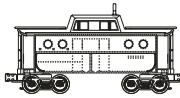

N5C (PRR only) or Steel Caboose

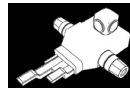
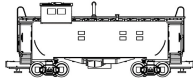

Lighted Lock-On

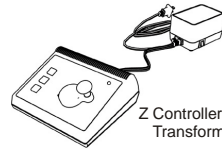

Z Controller and  
Transformer

## Tools Needed

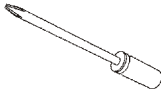

Philips Screwdriver



Pliers



Scissors



Cotton Swab or Rag



RailKing Maintenance Kit or  
Light Household Oil and Bearing Grease

## Optional Equipment



Microphone w/1/8" Plug



1/8" Male to Male Plug

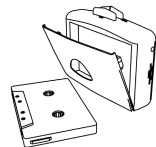

Cassette Player

**You can obtain replacement parts and replacement instructions from the M.T.H. Parts Department**

e-mail: [parts@mth-railking.com](mailto:parts@mth-railking.com)

phone: 410-381-2580

mail: 7020 Columbia Gateway Drive, Columbia MD 21046-1532

# Getting Started

## Assembling RealTrax®

The quick connectors and built-in roadbed allow you to set up RealTrax anywhere, including carpeted surfaces.

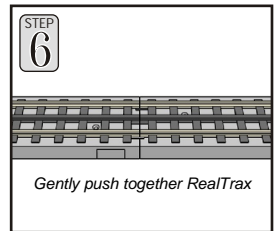
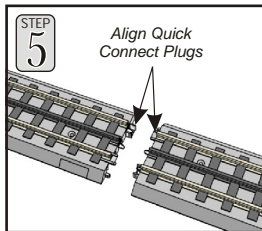
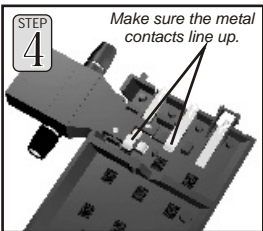
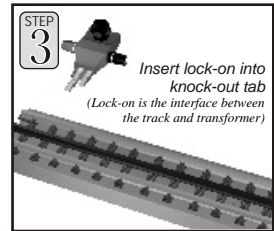
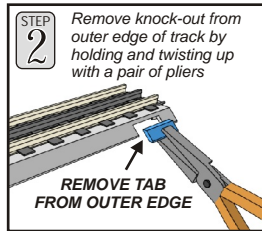
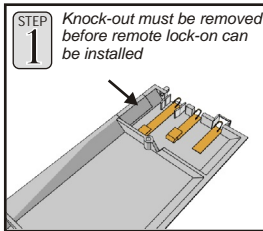

---

## Connecting the Transformer

The transformer included with this set provides an easy-to-use, safe power source for AC-powered trains and accessories.

To complete the connection between the track and the transformer, simply plug in the color-coded wire harness that was included in your set and plug the transformer into your wall outlet.

- Plug the wire from the transformer into the Z-Controller's center port.
- Connect the Wires from the Z-Controller to the Lighted Lock-On, being sure that the wires are connected from red-to-red and black-to-black.
- Unplug when not in use

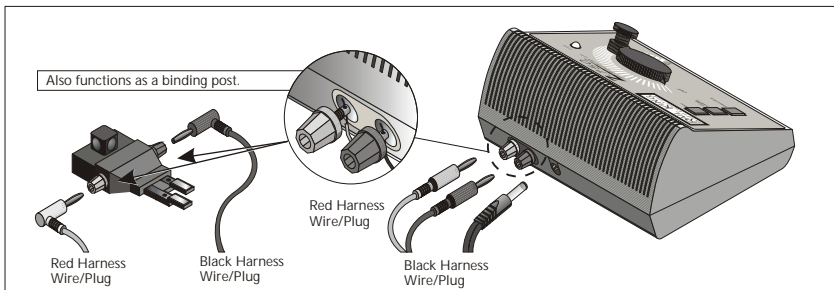

## Lubricating the Engine

Lubricate all exposed moving parts before operating, using a multi-purpose, plastic-compatible oil (available with M.T.H.'s Maintenance Kit, sold separately) or a light household oil. Follow the lubrication points.

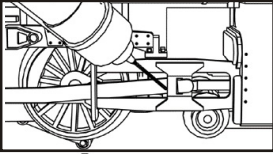

Lubricate Valve Gear

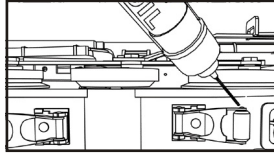

Lubricate Pick-Up Rollers  
(Do Not Oil the Flat Part of Pick-Up Rollers)

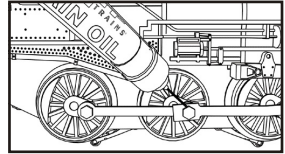

Lubricate Side Rods

## Priming the Smoke Unit

You should prime the smoke unit with smoke fluid before operating. Add 15-20 drops of smoke fluid from the included pipette through the smokestack, then gently blow into the stack to eliminate any air bubbles in the fluid.

If you choose not to prime the unit with fluid, turn the smoke unit switch located under the tender to the OFF position. **Running the engine without a primed smoke unit may cause damage.** See the "ProtoSmoke Unit Operation" section of this book for more information on smoke unit maintenance.

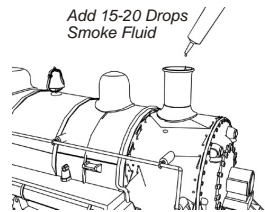

Add 15-20 Drops  
Smoke Fluid

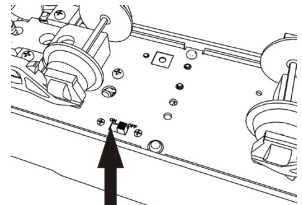

Smoke Unit  
ON/OFF Switch

**⚠ Running the engine without a primed smoke unit may cause damage**

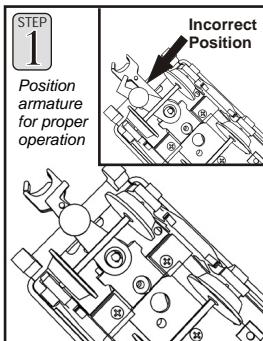

STEP 1

Position  
armature  
for proper  
operation

Incorrect  
Position

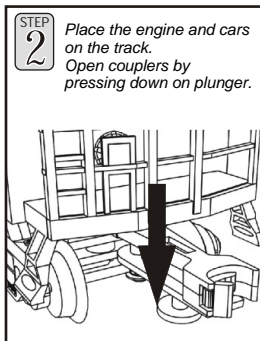

STEP 2

Place the engine and cars  
on the track.  
Open couplers by  
pressing down on plunger.

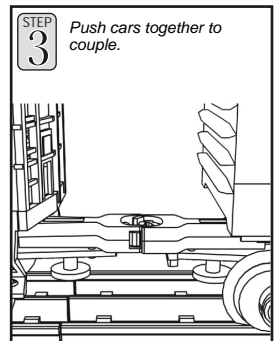

STEP 3

Push cars together to  
couple.

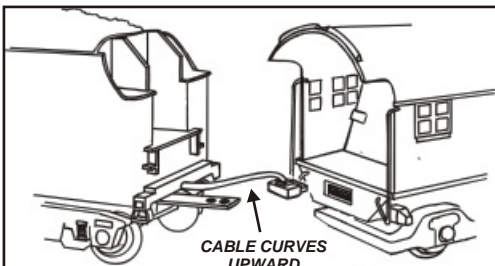

- Plug tender plug into boiler socket at the back of cab.
- Connect the draw bar between the engine and tender.



**DO NOT CONNECT  
This Engine To A  
Tender From  
Another Engine; It May  
Cause Serious Damage.**

*Look at the bottom of the engine and tender where each will have a color-coded stamp. If they match you may connect those two pieces; if not, don't.*

# Basic Operation

The Throttle knob controls how fast your train will travel.

- Turn the throttle knob up ½-way, until the engine and caboose lights shine bright.
- Put the engine into motion by pressing the Direction button on your transformer once. (hold it for approximately 1 second)

If the engine does not begin to move as soon as you firmly press the Direction button, you may not have sent enough voltage to the track to make the train move. Turn the throttle up a bit higher until the train begins to move.

## Operation Buttons

**Throttle** To increase or decrease track voltage, and therefore train speed, turn the throttle control knob. Turning it clockwise will increase voltage and speed, while turning it counterclockwise will decrease voltage and speed. The engine will maintain the speed you set after you release the throttle until you turn it again to change the voltage and speed.

**Horn/Whistle** - To sound the whistle, firmly press the Horn/Whistle button. The horn will sound for as long as you continue to depress the button. It will stop when you release the button.

**Bell** - To sound the bell, firmly press the bell button. The bell sound will continue until the bell button is firmly pressed a second time.

**Direction** Your train is programmed to start in neutral. The train will always cycle neutral-forward-neutral-reverse with each press and release of the direction button. The engine is programmed to restart in neutral each time the track voltage is turned off for 25 seconds or more.

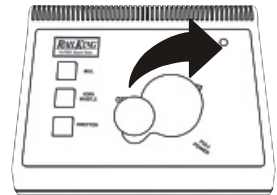

## Speed Control

M.T.H. engines equipped with Loco-Sound have speed control capabilities that allow the engine to maintain a constant speed up and down grades and around curves, much like an automobile cruise control. You can add or drop cars on the run, and the engine will maintain the speed you set.

While the engine is programmed to start with the speed control feature activated, you can opt to turn it off. This means the engine's speed will fall as it labors up a hill and increase as it travels downward. It is also affected by the addition or releasing of cars while on the run. To maintain a constant speed when speed control is turned off, you need to adjust track voltage yourself.

**To turn speed control on and off**, put the engine in neutral, then quickly tap the transformer's Whistle button one time then quickly tap the Bell button two times, allowing approximately ½ second to lapse between each quick button press. Repeat the 1 whistle, 2 bells code to return it to the other condition. **You will want to do this during the initial neutral upon start-up if you ever couple this engine to another engine that is not equipped with speed control to avoid damaging the motors in either engine.** Each time you shut down the engine completely, it will automatically turn speed control on.

## Direction Lock

You can lock your engine into a direction (forward, neutral, or reverse) so that it will not change directions. To do this, put the engine into the direction you want or into neutral, to lock it into neutral, run it at a very slow crawl (as slowly as it will move without halting), and quickly but firmly tap the Whistle button once followed by three quick taps of the Bell button, allowing approximately 1/2 second to lapse between each quick button press. The engine will not change direction (including going into neutral) until you repeat the 1 whistle, 3 bells code to return the engine to its normal condition, even if the engine is kept without power for extended periods of time.

Timing Chart				
Press Whistle Short & Firm	1/2 Sec. Pause	Press Bell Short & Firm	1/2 Sec. Pause	Press Bell Short & Firm
Total Time Lapse: 1 1/2 Seconds				

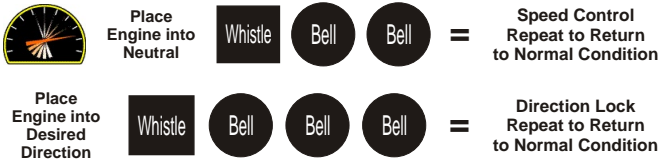

## Proto-Cast and Proto-Dispatch:

When used with the remote lock-on included in this set, Loco-Sound equipped engines gain Proto-Cast™ and Proto-Dispatch™ features.

### Proto-Cast:



Allows you to play audio recordings through your engine's speaker. Your set includes an audio source (a small portable CD/tape player) and a male-to-male mini cable (1/8" plug) to connect the audio source to the remote lock-on.

### To use Proto-Cast

- Plug the mini-cable *first* into your audio source (into the headphone jack)
- Plug Cable into the "Audio" port on the right side of the remote lock-on.
- Adjust the volume. If engine sounds keep breaking through the recorded sounds, increase the volume on the audio source.

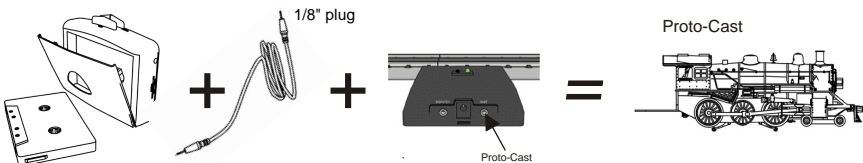



**Proto-Dispatch:** This feature allows you to broadcast your own voice through your engine's speaker. You must supply the microphone for use with the mini cable (1/8" plug) in this set to connect your microphone to the remote lock-on.



## To use Proto-Dispatch

- Connect the microphone to the mini-cable with 1/8" plug included in this set..
- Plug the "Cable" into the proto-dispatch port on the left side of the remote lock-on and speak into the microphone.



When these features are in use, the locomotive's own sounds (engine sounds and bells, whistles, and horns) will be muted so that only the sounds you broadcast will be heard.

Because Proto-Cast and Proto-Dispatch are voice activated, there will be a several second delay after you stop speaking into the microphone or turn off the audio source before the engine sounds resume. To stop using the feature and return to normal operation, unplug the cable from the lock-on jack.

If using parallel tracks with multiple Loco-Sound equipped engines, Proto-Cast and Proto-Dispatch transmissions from one track may be picked up by the other nearby engines.

If you experience popping and interference when using Proto-Cast or Proto-Dispatch, try cleaning the track as described in the "Cleaning the Wheels, Tires and Track" section of this booklet.

**NOTE: M.T.H. does not recommend using Proto-Cast and Proto-Dispatch at the same time.**

## Manual Volume Control

To adjust the volume of all sounds made by this engine, turn the master volume control knob located under the tender clockwise to increase the volume and counter-clockwise to decrease the volume.

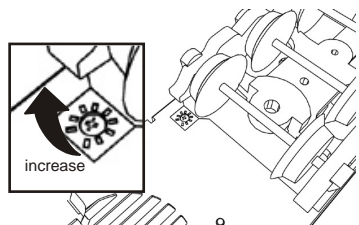

# Maintenance



## Lubrication Instructions

The engine should be oiled and greased in order to run properly.

Regularly lubricate all side rods and linkage components and pickup rollers to prevent squeaking. Use light household oil, such as that found in M.T.H.'s maintenance kit. Do not over oil. Use only a drop or two on each pivot point.

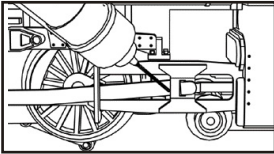

Lubricate Valve Gear

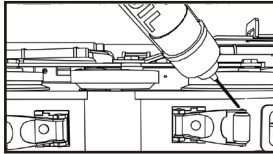

Lubricate Pick-Up Rollers  
(Do Not Oil the Flat Part of  
Pick-Up Rollers)

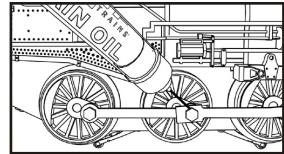

Lubricate Side Rods

## Greasing Instructions

The locomotive's internal gearing was greased at the factory. Grease engine every 50 hours of use or one year. Use a lithium based grease and follow the greasing instructions.

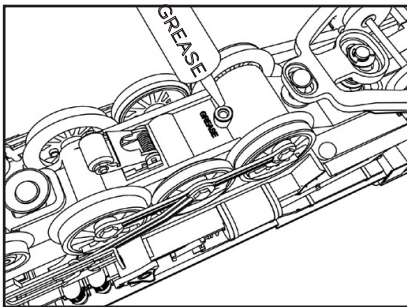

- Remove the screw from the chassis to open the grease port.
- Insert the grease tube tip into the port and squeeze the tube once or twice to add grease to the gearbox.
- Wipe off any excess grease and replace the phillips screw securely.

## Cleaning the Wheels, Tires and Track

Periodically check the locomotive wheels and pickups for dirt and buildup, which can cause poor electrical contact and traction and prematurely wear out the neoprene traction tires. Wheels and tires can be cleaned using denatured (not rubbing) alcohol applied with a cotton swab.



To clean the track, use RailKing Track Cleaning Fluid or denatured (not rubbing) alcohol and a clean rag. Unplug the transformer and wipe the rails of the track, turning the rag frequently to ensure that you are using clean cloth on the rails. Because the manufacturing process leaves a coating on RealTrax center rail, you should clean the rails after the first 30 minutes of use (you may notice an electrical smell during initial use as the coating wears off; this is normal). Thereafter, keep an eye on the track and clean it when it gets dirty to ensure good electrical contact and to lengthen the life of the tires.

## Traction Tire Replacement Instructions

Your locomotive is equipped with two neoprene rubber traction tires on the rear set of flanged drivers. While these tires are extremely durable, they may need occasionally need to be replaced.

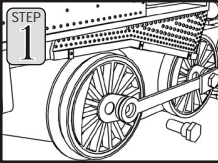

- Remove the side rod screws (the rods that connect each drive wheel to the other) from the wheels in order to slip the old tire off of the grooved drive wheel. These screws can be loosened with a 5mm nutdriver.
- Clean the groove using a cotton swab and denatured alcohol.

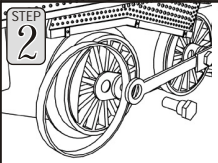

- Make sure the old tire has been completely removed from the groove in the drive wheel, using a razor blade or small flathead screwdriver to pry away any remains.
- Clean the groove using a cotton swab and denatured alcohol.
- Slip the new tire onto the wheel. You may find it useful to use two small flathead screwdrivers to stretch the tire over the wheel.
- If you twist the tire while stretching it over the wheel, you will need to remove and reinstall the tire. Otherwise your engine will wobble while operating.
- Make sure the tire is fully seated inside the groove. Use a razor blade to trim away any excess tire that doesn't seat itself inside the groove properly.

## ProtoSmoke® Unit Operation

This steam locomotive contains a smoke unit that outputs smoke through the smokestack on the boiler of the engine. The smoke unit is essentially a small heating element and wick that soaks up and then heats a mineral oil-based fluid that emits a harmless smoke. The smoke is then forced out of the stack by a small electric fan.

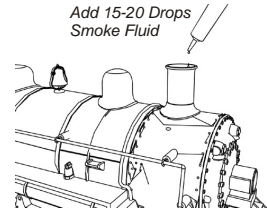

With a few easy maintenance steps, you should enjoy trouble-free smoke unit operation for years.

- When preparing to run this engine, add 15-20 drops of smoke fluid through the smokestack. We recommend M.T.H. ProtoSmoke, Seuthe, LGB, or LVTS fluids (a small pipette of ProtoSmoke fluid is included). Do not overfill the unit or the fluid may leak out and coat the interior engine components.
- If you choose not to add the fluid (or have already added the fluid but choose to run smoke-free), turn off the smoke unit switch located under the tender body. **Failure either to add fluid to the unit or to turn it off may damage the smoke unit heating element and/or wicking material.**
- When the smoke output while running the engine begins to diminish, add another 10-15 drops of smoke fluid or turn the smoke unit off.
- When storing the unit for long periods of time, you may want to add about 15 drops of fluid to prevent the wick from drying out.
- After removing the engine from storage, add another 25 drops of fluid, letting the wick soak up the fluid for 15 minutes prior to operation.

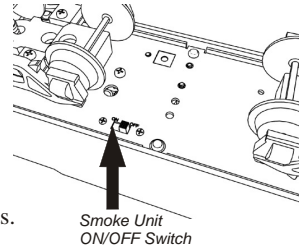

If you experience poor or no smoke output when the smoke unit is on and has fluid, check the wick to see if it has become hard, blackened, and unabsorbent around the heating element. Remove the boiler as shown below. Remove the smoke unit inspection cover from the locomotive's body (see right). After removing the chassis and inspection cover screws, lift the inspection plate away and inspect the wick. If it is darkly discolored and hard, it should be replaced. When priming new wick add 40 drops.

 **Running the engine without a primed smoke unit may cause damage**

## Locomotive Light Bulb Replacement

To replace the light bulb in the locomotive, follow the boiler removal instructions below.

STEP 1

Remove the six Phillips screws from the chassis then lift the body away from the chassis.

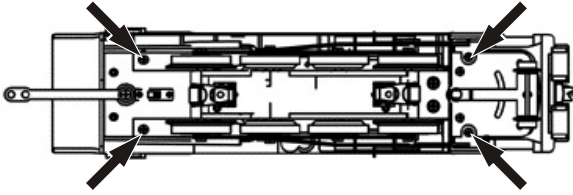

STEP 2

Once the locomotive boiler has been removed from its chassis, locate the bulb bracket as seen in the illustration on the right and rotate the headlight bulb counter-clockwise to remove.

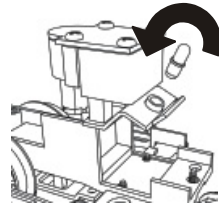

Replace Headlight Bulb

## Caboose Light Bulb Replacement

To replace the interior light bulbs follow these instructions and see the diagrams below.

STEP 1

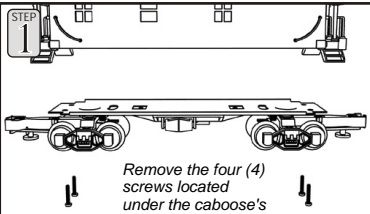

Remove the four (4) screws located under the caboose's

STEP 2

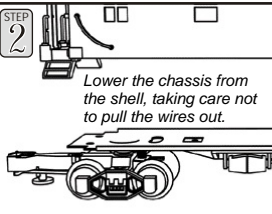

Lower the chassis from the shell, taking care not to pull the wires out.

STEP 3

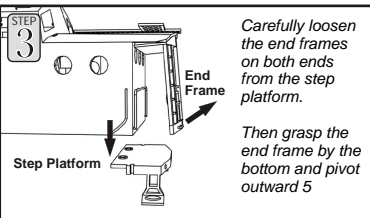

Carefully loosen the end frames on both ends from the step platform.

Then grasp the end frame by the bottom and pivot outward 5

STEP 4

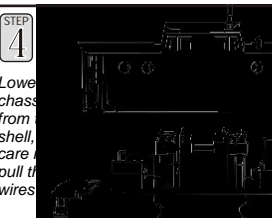

Lower chass from shell, care pull th wires

STEP 5

Replace a Bayonet Bulb by turning and pushing up, pulling the bulb from its socket.

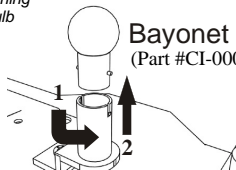

Bayonet Bulb  
(Part #CI-000015)

# Quick-Start DVD

The included Quick-Start DVD demonstrates the start-up and basic operation of this set as well as other information about model railroading. You may find it helpful to view the DVD before operating this set.

# RailWare Interactive CD ROM

M.T.H. provides a free RailWare CD ROM in each Ready-To-Run set. It is full of helpful information on M.T.H. product history, track planning software, a dealer finder, and information and video clips on Loco-Sound and Proto-Sound 2.0. Follow the directions below to use the CD ROM.

Minimum System Requirements: Pentium 100, 16MB RAM, Windows 95 or later, CD ROM drive, Sound Card, display properties set to greater than 256 colors. The CD will not work on a Mac OS unless you run VirtualPC®.

## Running RR-Track Software

You may run the RR-Track software directly off of the CD ROM or you may install the software to your hard drive.

1. On the Desktop, click on the icon that says My Computer.
2. Find your CD ROM drive.
3. With the M.T.H. CD ROM in the drive, double click on the icon for the CD ROM drive.
4. Find the folder on the CD ROM entitled INSTALLATION.
5. Choose the folder inside entitled RRTRAXSETUP.
6. Run the file in that folder called SETUP.EXE and follow the directions it provides.

The program may ask you for a registration code. If it does type in "M.T.H." and it will run.

Additional track libraries can be obtained directly from RR-Track. See their website for more information [www.rtrack.com](http://www.rtrack.com).

## Installing Adobe Acrobat Software

To read some of the electronic documents included on the CD ROM, you will need to install the Adobe Acrobat Reader® if it is not already on your computer. To install the software:

1. On the Desktop, click on the icon that says My Computer.
2. Find your CD ROM drive.
3. With the MTH CD ROM in the drive, double click on the icon for the CD ROM drive.
4. Find the folder on the CD ROM entitled INSTALLATION.
5. Choose the folder inside entitled ACROBAT READER.

\*If you are running Windows 95, 98 or NT choose the folder 32 BIT. Run the file AR32E301.EXE and follow the directions it provides.

If you have problems you cannot resolve by using these directions, contact [custserv@mth-railking.com](mailto:custserv@mth-railking.com) or call 410-381-2580 for further help.

# Troubleshooting Loco-Sound™ Problems

Although Loco-Sound has been designed and engineered for ease of use, you may have some questions during initial operation. The following table should answer most questions. If your problem cannot be resolved with this table, contact M.T.H. for assistance (e-mail: [service@mth-railking.com](mailto:service@mth-railking.com); telephone: 410-381-2580; fax: 410-423-0009; mail: 7020 Columbia Gateway Drive, Columbia MD 21046-1532).

<b>Starting Up</b>		<b>Remedy</b>
When I first turn the power on, the engine will not begin to run.	This is normal behavior. To prevent accidental high-speed start-ups, Loco-Sound is programmed to start up in neutral anytime track power has been turned off for several seconds. See the "Basic Operation" section for more details.	
The engine will not start after I press the Direction button.	You may not be sending enough power to the track to power the engine. Press the throttle up for a few more seconds to increase track power.	
<b>Whistle</b>		<b>Remedy</b>
I can't get the whistle to blow when I press the whistle button.	You may be pressing the button too quickly. Try pressing the whistle button more slowly, taking approximately one full second to fully depress the button.	
<b>Bell</b>		<b>Remedy</b>
I can't get the bell to ring when I press the bell button.	You may be pressing the button too quickly. Try pressing the bell button more slowly, taking approximately one full second to fully depress the button.	
<b>Lock-out</b>		<b>Remedy</b>
I can't get the engine to run after I power up the transformer. It sits still with the engine sounds running.	The engine may be locked into the neutral position. Follow the procedure in the "Lock into a Direction" section to unlock the engine's direction.	
The engine won't lock into forward, neutral, or reverse.	Engine speed must be below 10 scale mph (approx. 10 volts or less in conventional mode).	
<b>Volume</b>		<b>Remedy</b>
The sounds seem distorted, especially when the Horn or bell is activated.	Loco-Sound volume is set too high. Turn the volume control knob on the bottom of the tender counter-clockwise to reduce the volume.	
No sound.	Volume is set too low, adjust volume control knob on the bottom of the chassis clockwise to increase the volume or check connector to speaker.	
<b>Proto-Cast and -Dispatch</b>		<b>Remedy</b>
When I try to play music or my voice through my engine's speakers, there is popping and interference.	Clean the track with denatured alcohol, as described in the "Cleaning the Wheels, Tires, and Track" section of this book.	
My Proto-Cast sounds play too quietly or unclearly.	Unplug the cable between the audio source and the remote lock-on. Re-plug it into the audio source first, then into the lock-on, pushing firmly to make sure it is fully installed.	
When I try to play Proto-Cast, the engine's sounds keep breaking in on my recording.	Your recording may be playing too quietly to trigger the engine to stop playing its own sound set. Turn up the volume of the audio source you are using.	
When I run two Loco-Sound engines on tracks near each other, the Proto-Cast and Dispatch sounds play from both engines, not just from the one connected to the audio source or microphone.	This is normal behavior. Because Loco-Sound uses radio waves to transmit the sound to the engine, other Loco-Sound engines in the same range will also pick up the sound. Try moving one of the sets.	

# Compatibility

While this Ready-To-Run set is equipped with everything you need to operate it, the design allows flexibility. The train will operate on any traditional O-31 or larger O Gauge track system, including the RealTrax<sup>®</sup> included with this set or traditional tubular track. It is also compatible with most standard AC transformers, including the hobby transformer packaged with your set.

## Transformer Compatibility and Wiring Chart

Note that many of the operational commands described in these instructions require a bell button, so if you are using a transformer other than the one included in this set and your transformer does not have its own bell button, you should consider adding one to get the full benefit of the system.

Transformer Model	Center Rail	Outside Rail	Min/Max. Voltage	Power Rating	Transformer Type
MTH Z-500	Red Terminal	Black Terminal	0-18v	50-Watt	Electronic
MTH Z-750	Red Terminal	Black Terminal	0-21v	75-Watt	Electronic
MTH Z-1000	Red Terminal	Black Terminal	0-14v 0-18v	80-Watt 100-Watt	Electronic
MTH Z-4000	Red Terminal	Black Terminal	0-22v	390-Watt	Electronic
Lionel 1032	U	A	5-16v	90-Watt	Standard
Lionel 1032M	U	A	5-16v	90-Watt	Standard
Lionel 1033	U	A	5-16v	90-Watt	Standard
Lionel 1043	U	A	5-16v	90-Watt	Standard
Lionel 1043M	U	A	5-16v	90-Watt	Standard
Lionel 1044	U	A	5-16v	90-Watt	Standard
Lionel 1053	U	A	8-17v	60-Watt	Standard
Lionel 1063	U	A	8-17v	60-Watt	Standard
All-Trol	Left Terminal	Right Terminal	0-24v	300-Watt	Electronic
Dallee Hostler	Left Terminal	Right Terminal			Electronic
Lionel LW	A	U	8-18v	75-Watt	Standard
Lionel KW	A or B	U	6-20v	190-Watt	Standard
Lionel MW	Outside Track Terminal	Inside Track Terminal	5-16v	50V.A.	Electronic
Lionel RS-1	Red Terminal	Black Terminal	0-18v	50V.A.	Electronic
Lionel RW	U	A	9-19v	110-Watt	Standard
Lionel SW	U	A	Unknown	130-Watt	Standard
Lionel TW	U	A	8-18v	175-Watt	Standard
Lionel ZW	A,B,C or D	U	8-20v	275-Watt	Standard
Lionel Post-War Celebration Series ZW	A,B,C or D	Common	0-20v	135/190 Watt	Electronic



## 2-8-0 Steam Locomotive Engine Parts

Name and Number	Part #
1.) Stanchion ( black ) ( plastic )( 3.0mm long )	FB-1200242
2.) Handrail ( nickel )( boiler )	FB-1200099
3.) Bell ( nickel )	FB-1200101
4.) Boiler Shell ( PRR cab# 8014, #30-4103-OE )	FB-1200331
( SF cab# 2512, #30-4119-OE )	FB-1200337
5.) Lens ( green )( marker )	FA-1230025
6.) Lens ( clear )( headlight )	FA-1230022
7.) Number board ( PRR cab #8014 )	FB-1200332
( SF cab #2512 )	FB-1200338
8.) Smoke unit ( 7.0x8.0x2.0x3.7mm brass cup )( 7.5mm long posts ) ( Proto-Sound 2.0® & Loco Sound™ )	AA-0000029
9.) Bulb ( clear )( headlight ) ( 6V )( small globe )( screw base )	CA-0000038
10.) Bracket ( black ) ( smoke unit / headlight )	IH-0000085
11.) Screw ( 4/40x6.0mm )( roundhead )	IA-0000003
12.) Crosshead ( blackened finish ) ( 38.8mm long )	EC-1250036
13.) Drive rod ( blackened finish )	EC-1250037
14.) Drive block ( black )( 4 axle )	DF-1200018
15.) Bolt ( blackened finish ) ( hex head 5.0mm )( M3x9.5mm long ) ( 4.0x2.5mm shoulder )	IA-0000373
16.) Side rod ( blackened finish ) ( 116.0mm long )( 4 holes )	EC-1250038
17.) Traction tires	DE-0000023
18.) Insulator ( black ) ( top )( square )( pick-up )	BD-0000026
19.) Screw ( nickel ) ( M3x6.0mm )( roundhead )	IA-0000015
20.) Wire strap ( white ) ( metal )( tab bends over wires )	IH-0000103
21.) Tach board ( no spacer between board and optical sensor ) ( has a tiny resistor on backside of tach board )	AG-0000048
22.) Motor ( RS-365SH ) ( 8.0x21.0mm gear shaft )( 13.0mm gear threads ) ( 9.0x30.0mm white flywheel w/ black stripes ) ( tach board mounting strap )	BE-0000076
23.) Screw ( 6/32x8.0mm )( roundhead )	IA-0000050
24.) Motor mount ( black )	BI-0000034

26.) Wire nut ( yellow )	BI-4500003
27.) PC board ( green ) ( w/ 10 pin female plug )	AG-0000039
28.) Draw bar ( black ) ( 67.5mm long )	FB-1200079
29.) Spring ( 6.5x10.0mm )( w/ 0.6mm thick wire )	IE-0000061
30.) Screw ( 4/40x6.0mm )( washer head )	IA-0000028
31.) Nut ( nickel )( 2.5x5.0x10.0mm )	IC-0000005
32.) Insulator ( black ) ( pick-up )( bottom )( flat )( square )	BD-0000024
33.) Pick-up ( 8.0x11.0mm roller )( 24.0mm long )	BD-0000050
34.) Bolt ( nickel ) ( M3x9.5mm long )( 4.0x2.5mm shoulder ) ( 5.0mm hex head )	IA-0000253
35.) Truck ( lead )( single axle )	DA-1230013
36.) E-clip ( 2.5x6.0x0.5mm )	IF-0000004
37.) Washer ( 3.0x7.0x0.4mm )	ID-0000028
38.) Spring ( 6.5x11.0mm )( w/ 0.4mm thick wire )	IE-0000007
39.) Pin ( 3.0x9.0mm )( flathead )( 1 e-clip groove )	IG-0000007
40.) Pivot plate ( nickel ) ( for lead truck )	IH-0000021
41.) Bracket ( black ) ( metal )( 18.6x32.4x40.5mm )( T shaped )	IH-0000211
42.) Ferrite bead	AI-0000030
43.) Capacitor ( blue )( .01 uF ) ( 16.0x2.0mm )( w/ 2 wires )	AI-0000031
44.) Steam dome ( black )	FB-1200247
45.) Sand dome ( black )	FB-1200246
46.) Washer ( black ) ( 3.0x6.0x0.4mm )( fiber )	ID-0000040

# 2-8-0 Steam Locomotive Engine Parts

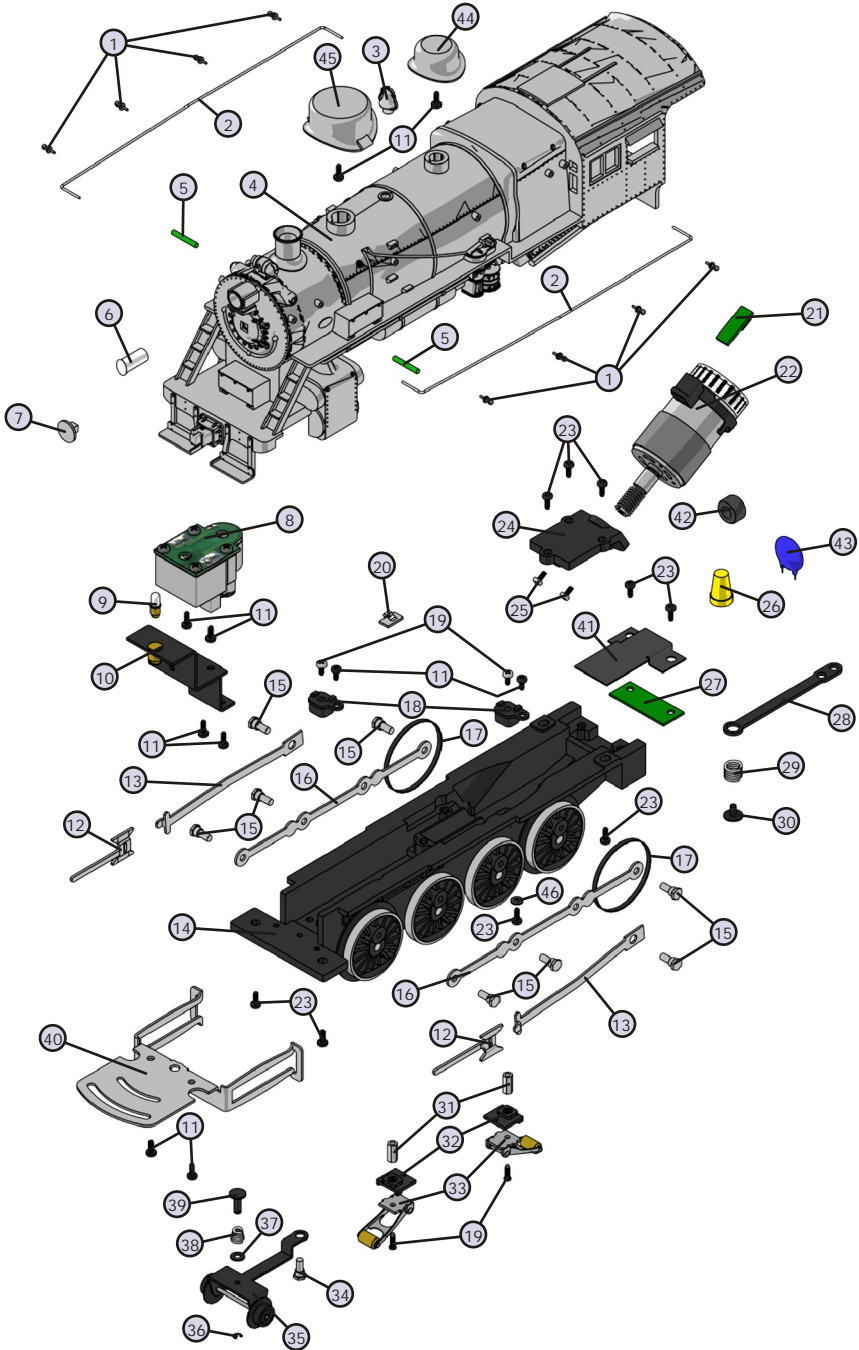

## 2-8-0 Steam Engine Tender Parts

Name and Number	Part #
1.) Tender Shell ( PRR, # 30-4103-OE ) (SF, # 30-4119-OE)	GA-1200125 GA-1200128
2.) Board ( Loco-Sound™ )( steam/turbine )	AE-0000003
3.) Screw ( 4/40x8.0mm )( roundhead )	IA-0000011
4.) Insulator ( white ) ( washer )( 3.0x6.0x3.0mm )( plastic )	ID-0000025
5.) Insulator ( clear ) ( 13.0x19.0x0.1mm )( single hole )	ID-0000024
6.) Screw ( M3x4.0mm )( roundhead )	IA-0000010
7.) Screw ( M3x6.0mm )( roundhead )	IA-0000016
8.) Wire nut ( yellow )	BI-4500003
9.) Speaker cone ( black ) ( 44.0x48.3x37.0mm )( plastic )( 2 screw hole tabs )	BF-0000020
10.) Speaker ( 8 ohm )	BF-0000015
11.) Wire harness ( black )	BC-1200103
12.) Screw ( M2x4.0mm )( roundhead )	IA-0000058
13.) Switch ( small )	BB-0000009
14.) Screw ( 4/40x6.0mm )( roundhead )	IA-0000003
15.) Bracket ( Aluminum ) ( for Loco-Sound™ board ) ( 14.0x76.0x24.7mm )( 5.0mm step )	IH-0000212
16.) Screw ( M3x8.0mm )( roundhead )	IA-0000035
17.) Volume pot ( small ) ( blue w/ green board )	BI-0000040
18.) Spacer ( black ) ( 3.0x6.0x4.0mm )( plastic )	ID-0000071
19.) Chassis ( black ) ( 58.0x175.0mm )( has new hole for battery jack )	GB-1200047
20.) Screw ( M3x16.0mm )( washer head )( self-drilling threads )	IA-0000025
21.) T-bar	IG-0000001
22.) Coupler ( black ) ( mechanical )( 51.5mm long )	DD-0000039
23.) Armature ( black ) ( 45.0mm long )	DD-0000040
24.) Spring ( 6.5x11.0mm )( w/ 0.4mm thick wire )	IE-0000007

25.) Washer ( black )(plastic) ( 4.6x8.6x2.0mm )( inside 7.0x1.0mm )( cup shaped )	ID-0000060
26.) E-clip ( 3.0x8.0x0.5mm )	IF-0000002
27.) Truck ( black ) ( tender )( 2 axle )	DA-1250012
28.) Screw ( 6/32x6.0mm )( washer head )	IA-0000214
29.) Gasket ( black ) ( speaker ring )( 43.8x49.8x3.0mm )( foam )	IB-0000009
NS.) Wire harness ( 12 pin black male plug )	BC-1200104

# 2-8-0 Steam Engine Tender Parts

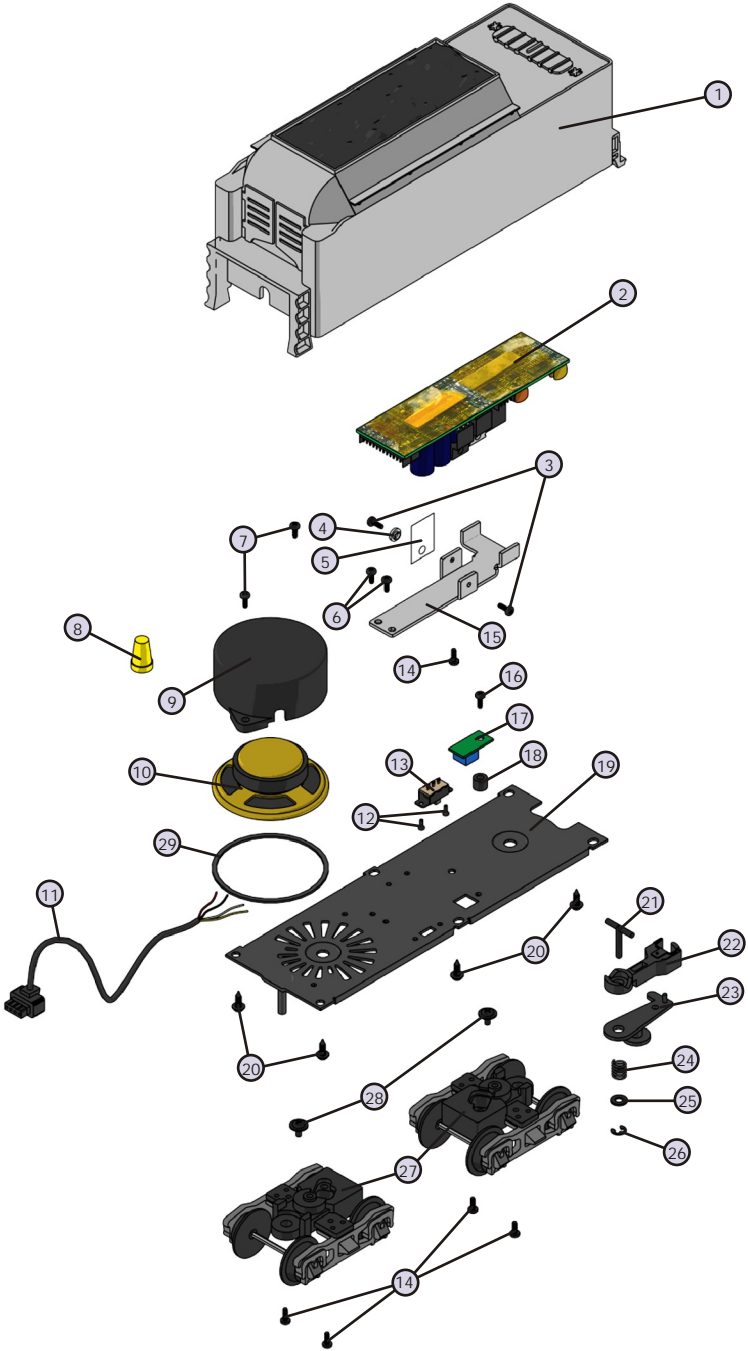

# Service & Warranty Information

## How to Get Service Under the Terms of the Limited One-Year Warranty

When you suspect an item is defective, please check the operator's manual for standard operation and trouble-shooting techniques that may correct the problem. Additional information may be found on the M.T.H. Website. Should you still require service, follow the instructions below to obtain warranty service.

First, e-mail, write, call or fax a M.T.H. Authorized Service Center (ASC) in your area to obtain Repair Authorization. You can find the list of ASCs on the M.T.H. Website, [www.mth-railking.com](http://www.mth-railking.com). Authorized Service Centers are required to make warranty repairs on items sold *only* from that store; all other repairs may-- or may not be done at the store's own discretion. If you did not purchase the item directly from the ASC, you will need to select a National Authorized Service Center (NASC). These centers are compensated by M.T.H. to perform warranty service for any customer whose repair qualifies for warranty service. A list of NASC retailers can be located on the M.T.H. Website or by calling 1-888-640-3700. Should the warranty no longer apply, you may choose either an ASC or NASC retailer to service your M.T.H. Product. A reasonable service fee will be charged.

**CAUTION:** Make sure the product is packed in its original factory packaging including its foam and plastic wrapping material to prevent damage to the merchandise. There is no need to return the entire set if only one of the components is in need of repair *unless otherwise instructed by the Service Center. The shipment must be prepaid and we recommend that it be insured. A cover letter including your name, address, daytime phone number, e-mail address (if available), Return Authorization number (if required by the service center, a copy of your sales receipt and a full description of the problem must be included to facilitate the repairs. Please include the description regardless of whether you discussed the problem with a service technician when contacting the Service Center for your Return Authorization.*

Please make sure you have followed the instructions carefully before returning any merchandise for service. Authorized M.T.H. Service Centers are independently owned and operated and are not agents or representatives of M.T.H. Electric Trains. M.T.H. assumes no responsibility, financial or otherwise, for material left in their possession, or work done, by privately owned M.T.H. Authorized Service Centers.

If you need assistance at any time email MTH Service at [service@mth-railking.com](mailto:service@mth-railking.com), or call 410 381-2580.

## Limited One-Year Warranty

**All M.T.H. products purchased from an Authorized M.T.H. Train Merchant are covered by this warranty.**

See our website at [www.mth-railking.com](http://www.mth-railking.com) or call 1-888-640-3700 to identify an Authorized M.T.H. Train Merchant near you.

M.T.H. products are warranted for one year from the date of purchase against defects in material or workmanship, excluding wear items such as light bulbs, pick-up rollers, batteries, smoke unit wicks, and traction tires. We will repair or replace (at our option) the defective part without charge for the parts or labor, if the item is returned to the M.T.H. Authorized Service Center (ASC) where it was purchased or a M.T.H. National Authorized Service Center (NASC) within one year of the original date of purchase. This warranty does not cover damages caused by improper care, handling, or use. Transportation costs incurred by the customer are not covered under this warranty.

Items sent for repair must be accompanied by a return authorization number, a description of the problem, and a **copy of the original sales receipt from an Authorized M.T.H. Train Merchant**, which gives the date of purchase. If you are sending this product to an Authorized Service Center, contact that Center for their return authorization.

This warranty gives you specific legal rights, and you may have other rights that vary from state to state. Specific questions regarding this warranty may be forwarded to M.T.H. directly.

Service Department  
M.T.H. Electric Trains  
7020 Columbia Gateway Drive  
Columbia MD 21046-1532



# AUTHORIZED SERVICE CENTER

7020 Columbia Gateway Dr. - Columbia, MD 21046

Information: 410-381-2580 Fax: 410-381-6122

[www.mth-railking.com](http://www.mth-railking.com)

## PARTICIPATING A.S.C. RETAILER LIST

### ALABAMA

SOUTHERLAND STATION  
HUNTSVILLE  
256-533-4720

### ARIZONA

ARIZONA TRAIN DEPOT  
MESA  
480-833-9486

### CALIFORNIA

CENTRAL COAST TRAINS  
ATASCADERO  
805-466-1391

### TRAIN SHACK

BURBANK  
818-842-3330

### REED'S HOBBY SHOP

LA MESA  
619-464-1672

### ROUNDHOUSE

NORTH HOLLYWOOD  
818-769-0403

### DOLLHOUSES, TRAINS & MORE

NOVATO  
415-883-0388

### TIN PLATE JUNCTION

OAKLAND  
510-444-4780

### RON'S WORLD

SAN CLEMENTE  
949-361-5596

### BLACK NIGHT TRAINS & HOBBIES

SANTA ROSA  
707-523-3522

### COLORADO

CUSTOM RAILWAY SUPPLY  
COLORADO SPRINGS  
719-634-4616

### CABOOSE HOBBIES, INC.

DENVER  
303-777-6766

### MIZELL TRAINS

WESTMINSTER  
303-429-4811

### CONNECTICUT

TIME MACHINE HOBBY, LL C  
MANCHESTER  
860-646-0610

### FLORIDA

AMHERST DEPOT  
ENGLEWOOD  
941-475-2020

### DEPOT HOBBY SHOP

IANTANA  
561-585-1982

### HOLLYWOOD STATION

MIAMI  
954-921-2700

### READY TO ROLL

MIAMI  
305-688-8868

### COLONIAL PHOTO & HOBBY

ORLANDO  
407-841-1485

### WARRICK CUSTOM HOBBIES

PLANTATION  
954-370-0708

### ROUNDHOUSE SOUTH

PORT ORANGE  
386-304-7002

### ILLINOIS

BERWYN'S TOY TRAINS &  
MODELS  
BERWYN  
708-484-4384

### CHICAGOLAND HOBBY

CHICAGO  
773-775-4848

### BILL'S ENGLEWOOD STATION

ORLAND PARK  
708-460-4906

### BIKE & CHOO CHOO

CONNECTION  
SCHAUMBURG  
847-882-7728

### INDIANA

Y. O. R. K. TRAINS  
MUNSTER  
219-838-9999

### SAMUELSON'S TRAIN SHOP

VALPARAISO  
219-462-2708

### IOWA

CABOOSE STOP HOBBIES  
CEDAR FALLS  
800-642-7012

### KANSAS

HOBBY HAVEN  
OVERLAND PARK  
913-381-3111

### KENTUCKY

L & N TRAINS & THINGS  
LOUISVILLE  
502-897-9005



LOUISIANA

AMERICA'S TRAIN YARD  
BATON ROUGE  
225-926-5592

MAINE

WHEELS, WINGS & THINGS  
LUDLOW  
207-532-6277

MARYLAND

HOBBYTOWN U S A  
FREDERICK  
301-694-7395

FREDERICK JUNCTION  
FREDERICK  
301-694-3434

ENGINE HOUSE HOBBIES  
GAITHERSBURG  
301-590-0816

J & B TRAINS  
HAGERSTOWN  
240-420-4930

THE TRAIN ROOM  
HAGERSTOWN  
301-745-6681

PURKEY'S TOY TRAINS  
SYKESVILLE  
410-549-6061

CATOCTIN MOUNTAIN TRAINS  
& HOBBIES  
THURMONT  
301-694-8331

E.L. JONES & SONS  
WILLIAMSPORT  
800-810-8138

MASSACHUSETTS

FLYING YANKEE HOBBY  
SHOP  
BOSTON  
617-323-9702

NORTHEAST TRAINS  
PEABODY  
978-532-1615

EAST BAY HOBBIES  
SEEKONK  
508-336-5573

PIONEER VALLEY HOBBIES  
W. SPRINGFIELD  
413-732-5531

MICHIGAN

MICHIGAN MODEL TRAIN  
CENTER  
PINCKNEY  
734-426-1651

BRASSEUR ELECTRIC  
TRAINS INC.  
SAGINAW  
989-793-4753

MINNESOTA

DON'S HOBBY CO.  
MANKATO  
507-387-1330

MISSOURI

SWITCH STAND  
SAINT LOUIS  
314-781-4458

MARK TWAIN HOBBY CENTER  
ST. CHARLES  
636-946-2816

NEVADA

RENO RAILS  
RENO  
775-337-6669

NEW HAMPSHIRE

TREASURED TOYS  
SALEM  
603-898-7224

NEW JERSEY

HOBBY SHOP  
ABERDEEN  
732-583-0505

COUNTRY AND STUFF  
ANDOVER  
973-786-7086

GENE'S TRAINS  
BRICK  
732-840-9728

COLUMBUS TRAIN STATION  
COLUMBUS  
609-518-1800

ATLANTIC RAILS  
HAMMONTON  
609-567-8490

C B TRAIN DEPOT  
HILLSDALE  
201-666-9598

GRAND CENTRAL STATION  
KEARNY  
201-955-6200

J & B TRAINS, INC.  
MAPLE SHADE  
856-414-0092

HOBBYMASTERS, INC  
RED BANK  
732-842-6020

RIDGEFIELD HOBBY  
RIDGEFIELD  
201-943-2636

TOM'S MODEL TRAINS  
SCOTCH PLAINS  
908-322-6122

TRAINS & THINGS  
TRENTON  
609-883-8790

HOLLY BEACH TRAIN DEPOT  
WILDWOOD  
609-522-2379

NEW YORK

L B C MODEL TRAINS  
BUFFALO  
716-631-3081

KURT'S TRAINS & HOBBIES  
CALEDONIA  
585-538-2960

AURORA RAILS & HOBBIES  
EAST AURORA  
716-652-5718

NASSAU HOBBY CENTER,  
INC.  
FREEPORT  
516-378-9594

J & R JUNCTION  
LIVERPOOL  
315-451-6551

HOBBY WORLD  
MONTICELLO  
845-794-8770

CITY DEPOT, INC.  
NEW HAMPTON  
845-374-3010

THIRD STREET DEPOT  
NIAGARA FALLS  
716-285-6464

ISLAND TRAINS  
STATEN ISLAND  
718-317-0008

SCAG'S ELECTRIC TRAIN  
SHOP  
STATEN ISLAND  
718-727-7373

AMERICANA STORE  
TIVOLI  
845-757-4246

KROSS HARDWARE  
WEST BABYLON  
631-669-3069

WESTCHESTER CENTRAL  
TRAINS  
WHITE PLAINS  
914-421-1262

NORTH CAROLINA

THE ROUNDHOUSE &  
BACKSHOP  
CARY  
919-465-0810

DRY BRIDGE STATION  
MOUNT AIRY  
336-786-9811

THE FREIGHT YARD  
SMITHFIELD  
919-934-6229

LITTLE CHOO CHOO SHOP  
INC.  
SPENCER  
704-637-8717

TRAIN LOFT  
WINSTON-SALEM  
336-760-9817

OHIO  
E & S TRAINS  
AKRON  
330-745-0785

T & K HOBBY SHOP  
BRIDGEPORT  
740-633-6607

PARMA HOBBY  
CLEVELAND  
216-741-6440

SANDY'S HOBBY'S &  
COLLECTIBLES  
ELYRIA  
440-365-9999

DUNHAM'S TOY TRAINS  
LONDON  
740-852-0899

CLEARVIEW TRAIN & HOBBY  
LORAIN  
440-277-4488

DIXIE UNION STATION  
MASON  
513-459-0460

DAVIS TRAINS  
MILFORD  
1-800-448-1060

ERIE RAILWAY DEPOT  
TROY  
937-440-9922

PENNSYLVANIA  
AMERICAN HOBBY CENTER  
ALQUIPPA  
724-378-3930  
BUSSINGER TRAINS  
AMBLER  
215-628-2366

JIM'S HOBBY SERVICE  
BERWICK  
570-759-2695

YE OLDE TRAIN &  
CHRISTMAS SHOPPE  
BOYERTOWN  
610-369-0755

NICHOLAS SMITH TRAINS  
BROOMALL  
610-353-8585

CHARLEROI SWEEPER  
CENTER  
CHARLEROI  
724-483-3397

JERRY QUINN TRAINS & TOYS  
COATESVILLE  
610-383-1931

CRANBERRY HOBBY DEPOT  
CRANBERRY TWP  
724-776-3640

FAIRCHANCE PHARMACY  
FAIRCHANCE  
724-564-7817

TRAINS R FUN  
FRAZER  
610-644-4585

THE CABOOSE  
LEHIGHTON  
570-386-5352

SCHUYLKILL FLYER HOBBIES  
LEESPORT  
484-248-2100

HOBBY CITY  
McMURRAY  
724-942-2557

ENGLISH MODEL RR  
MONTOURSVILLE  
800-327-5126

STATION/M H INDUSTRIES  
NEW CUMBERLAND  
717-774-7096

FRYER'S STORE  
ORWIGSBURG  
570-366-2258

TOBY TYLER'S HOBBY  
CENTER  
PITTSBURGH  
412-653-5030

WILCOX GREENHOUSE &  
NURSERY  
TITUSVILLE  
814-827-3823

EASTERN DEPOT  
TROY  
570-297-1975

J & J RAILROAD CROSSING  
INC  
TURTLE CREEK  
412-824-6009

THE TRAIN SHOPPE & HOBBY  
CENTER LD  
WILKES BARRE  
570-824-7688

RHODE ISLAND  
GRANDMA'S HOUSE  
GRANDPA'S TRAIN  
WARWICK  
401-463-7803

SOUTH CAROLINA  
EMERALD TRAIN & HOBBY  
GREENWOOD  
864-223-2247

TENNESSEE  
MODEL RAILROAD & HOBBY  
SHOP  
MEMPHIS  
901-384-6500

TRAINS-N-THINGS  
PARIS  
731-641-8880

TEXAS  
HOBBY TIME  
AMARILLO  
806.352.9660

RIVERVIEW TRAINS  
ANGLETON  
979-848-3895

GREAT TRAINS & HOBBIES  
LONGVIEW  
903-757-2720

UTAH  
ALMOSTA JUNCTION  
CLEARFIELD  
801-776-1656

VIRGINIA  
LEESBURG HOBBIES &  
COLLECTIBLES  
LEESBURG  
703-779-8600

LOCUST GROVE TRAINS  
LOCUST GROVE  
540-854-8955

TRAINS, ETC.  
LORTON  
703-550-1779

TRAIN DEPOT  
MANASSAS  
703-335-2216

CHESTERFIELD HOBBIES  
MIDLOTHIAN  
804-379-9091

DAVIS HOBBY SUPPLIES  
PORTSMOUTH  
757-397-1983

TOY TRAIN CENTER  
RICHMOND  
804-288-4475

T S G HOBBIES  
WARRENTON  
540-347-9212

NORGE STATION  
WILLIAMSBURG  
757-564-7623

WASHINGTON  
EASTSIDE TRAINS  
KIRKLAND  
425-828-4098

WEST VIRGINIA  
PATRICK'S TRAINS  
WHEELING  
304-232-0714

WISCONSIN  
WOODCRAFTERS SHOP  
BURLINGTON  
262-763-5239

SOMMERFELD'S TRAINS  
BUTLER  
262-783-7797  
HOBBY OUTLET  
FOND DU LAC  
920-924-3770

G B T V & TRAINS  
GREEN BAY  
920-496-9697

GRAMPA'S TRAIN SHOP  
RICE LAKE  
715-234-2996

CANADA  
TOY TRAIN WORKSHOP  
CUMBERLAND  
613-833-8331

THE TRAIN ROOM  
FERGUS  
19-787-3280

CREDIT VALLEY RAILWAY  
COMPANY  
TREETSVILLE  
905-826-1306

B&H TRAINS  
TERREBONNE  
514-793-9696

## PARTICIPATING N.A.S.C. LIST

CALIFORNIA  
TIN PLATE JUNCTION  
OAKLAND  
510-444-4780

COLORADO  
MIZELL TRAINS  
WESTMINSTER  
303-429-4811

CONNECTICUT  
TIME MACHINE HOBBY, LL C  
MANCHESTER  
860-646-0610

FLORIDA  
COLONIAL PHOTO & HOBBY  
ORLANDO  
407-841-1485

ROUNDHOUSE SOUTH  
PORT ORANGE  
386-304-7002

ILLINOIS  
CHICAGOLAND HOBBY  
CHICAGO  
773-775-4848

KENTUCKY  
L&N TRAINS & THINGS  
LOUISVILLE  
502-897-9005

MARYLAND  
ENGINE HOUSE HOBBIES  
GAITHERSBURG  
301-590-0816

CATOCTIN MOUNTAIN TRAINS  
& HOBBIES  
THURMONT  
301-694-8331

MICHIGAN  
MICHIGAN MODEL TRAINS  
PINCKNEY  
734-426-1651

BRASSEUR ELEC. TRAINS  
SAGINAW  
989-793-4753

NEW HAMPSHIRE  
TREASURED TOYS  
SALEM  
603-898-7224

NEW YORK  
L B C MODEL TRAINS  
BUFFALO  
716-631-3081

AURORA RAILS & HOBBIES  
EAST AURORA  
716-652-5718

THIRD STREET DEPOT  
NIAGARA FALLS  
716-285-6464

OHIO  
DAVIS TRAINS  
MILFORD  
1-800-448-1060

PENNSYLVANIA  
BUSSINGER TRAINS  
AMBLER  
215-628-2366

JIM'S HOBBY SERVICE  
BERWICK  
570-759-2695

FAIRCHANCE PHARMACY  
FAIRCHANCE  
724-564-7817

ENGLISH MODEL RR  
MONTOURSVILLE  
800-327-5126

TOBY TYLER'S HOBBY CEN.  
PITTSBURGH  
412-653-5030

VIRGINIA  
LOCUST GROVE TRAINS  
LOCUST GROVE  
540-854-8955

DAVIS HOBBY SUPPLIES  
PORTSMOUTH  
757-397-1983

T S G HOBBIES  
WARRENTON  
540-347-9212

WISCONSIN  
SOMMERFELD'S TRAINS  
BUTLER  
262-783-7797

GRAMPA'S TRAIN SHOP  
RICE LAKE  
715-234-2996

CANADA  
TOY TRAIN WORKSHOP  
CUMBERLAND  
13-833-8331

THE TRAIN ROOM  
FERGUS  
519-787-3280