



# 0-4-0 Dockside Freight Set

## Operation Manual



[www.railking.com](http://www.railking.com)

Thank you for purchasing this RailKing product.  
**PLEASE READ BEFORE USE AND SAVE**



# Table of Contents

<b>Set Up Checklist</b> .....	<b>3</b>
<b>Getting Started</b> .....	<b>4</b>
Assembling RealTrax® .....	4
Plugging in the Transformer .....	4
Lubricating the Engine .....	5
Priming the Smoke Unit .....	5
Coupling the Engine and Cars .....	5
<b>Basic Operation</b> .....	<b>7</b>
Operation Buttons .....	7
Direction Lock .....	7
<b>Maintenance</b> .....	<b>7</b>
Lubrication and Greasing Instructions .....	8
Cleaning the Wheels, Tires and Track .....	9
ProtoSmoke® Unit Operation .....	9
Locomotive Light Bulb Replacement .....	10
Caboose Light Bulb Replacement .....	10
<b>RailWare Interactive CD ROM</b> .....	<b>11</b>
<b>Troubleshooting</b> .....	<b>12</b>
<b>Compatibility</b> .....	<b>13</b>
<b>Transformer Compatibility Chart</b> .....	<b>13</b>
<b>Exploded View Parts</b> .....	<b>14</b>
<b>Service and Warranty Information</b> .....	<b>17</b>
<b>Authorized Service Centers</b> .....	<b>18</b>

**CAUTION: ELECTRICALLY OPERATED PRODUCT:**

Not recommended for children under 10 years of age. M.T.H. recommends adult supervision with children ages 10 - 16. As with all electric products, precautions should be observed during handling and use to reduce the risk of electric shock.

**WARNING:** When using electrical products, basic safety precautions should be observed, including the following: Read this manual thoroughly before using this device.

- M.T.H. recommends that all users and persons supervising use examine the hobby transformer and other electronic equipment periodically for conditions that may result in the risk of fire, electric shock, or injury to persons, such as damage to the primary cord, plug blades, housing, output jacks or other parts. In the event such conditions exist, the train set should not be used until properly repaired.
- Do not operate your layout unattended. Obstructed accessories or stalled trains may overheat, resulting in damage to your layout.
- This train set is intended for indoor use. Do not use if water is present. Serious injury or fatality may result.
- Do not operate the hobby transformer with damaged cord, plug, switches, buttons or case.
- The transformer was designed to operate on regular US household current (120 volt, 50-60 Hertz). Do not connect to any other source of power.
- To avoid the risk of electrical shock, do not disassemble the transformer unit. There are no user-serviceable parts inside. If the unit is damaged contact M.T.H. Service for instructions.
- The transformer is equipped with an internal circuit protector. If the circuit protector trips, unplug the power cord from the electrical wall outlet, check your layout for any short circuits. The circuit breaker will reset automatically when the short is removed from the circuit.
- Unplug the transformer from the electrical wall outlet when not in use.
- Do not use this transformer for other than its intended purpose.

**Transformer Ratings:**

Input: 120 VAC, 60 Hz Only, Output: 21 VAC, 3.75A, 78 VA

This product may be protected by one or more of the following patents: 6,019,289; 6,280,278; 6,281,606; 6,291,263; 6,457,681; 6,491,263; 6,604,641; 6,619,594; 6,624,537; 6,655,640.

©2004, M.T.H. Electric Trains, Columbia, MD 21046

# Set Up Checklist

- Assemble RealTrax®
- Connect the transformer
- Lubricate the engine
- Prime the smoke unit
- Place the engine and cars on the track and couple them together
- Apply power to run as described in the Basic Operation section of these instructions.

## Set Includes



Steam Engine with Whistle



Gondola Car or Tank Car

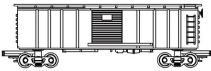
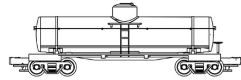

Box Car



Lighted Work Caboose



8-Pieces  
O-31 Curve RealTrax

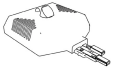

Lock-On



Transformer

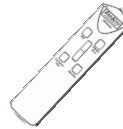

Remote Control

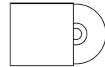

DVD/CD-Rom

## Tools Needed



Pliers



Scissors

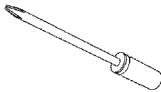

Philips Screwdriver



Cotton Swab or Rag



RailKing Maintenance Kit or  
Light Household Oil and Bearing Grease

**You can obtain replacement parts and replacement instructions from the M.T.H. Parts Department**

e-mail: [parts@mth-railking.com](mailto:parts@mth-railking.com)

phone: 410-381-2580

mail: 7020 Columbia Gateway Drive, Columbia MD 21046-1532

# Getting Started

## Assembling RealTrax®

The quick connectors and built-in roadbed allow you to set up RealTrax anywhere, including carpeted surfaces.

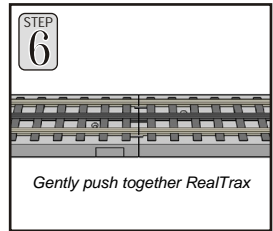
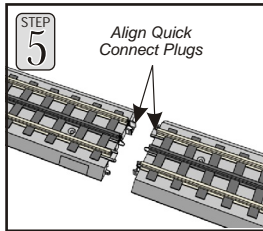
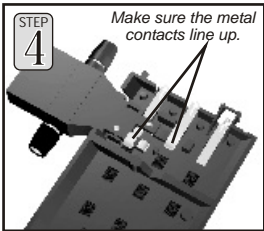
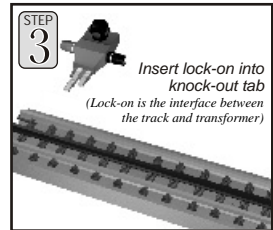
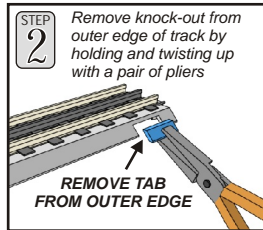
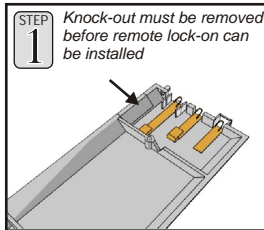

## Connecting the Transformer

The power supply included with this set provides an easy-to-use, safe power source for AC-powered trains and accessories.

- Plug the wire from the transformer into the remote lock-on's center port, then plug the transformer into the wall outlet.
- Unplug when not in use.

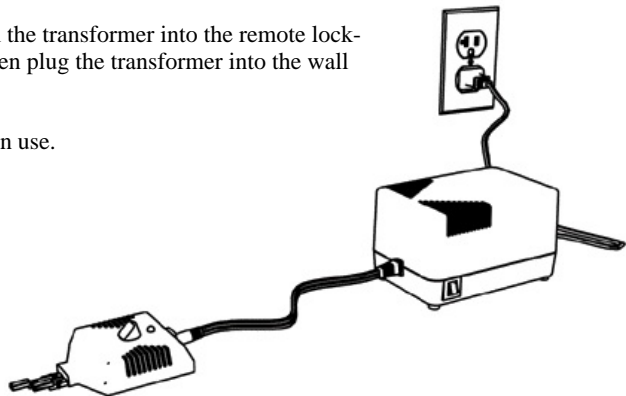

## Lubricating the Engine

Lubricate all exposed moving parts before operating using a multi-purpose, plastic-compatible oil (available with M.T.H.'s Maintenance Kit, sold separately) or a light household oil. Follow the lubrication instructions on page 8.

## Priming the Smoke Unit

You should prime the smoke unit with smoke fluid before operating. Add 15-20 drops of smoke fluid from the included pipette through the smokestack, then gently blow into the stack to eliminate any air bubbles in the fluid.

If you choose not to prime the unit with fluid, turn the smoke unit switch located under the engine to the OFF position. **Running the engine without a primed smoke unit may cause damage.** See the "ProtoSmoke Unit Operation" section of this book for more information on smoke unit maintenance.

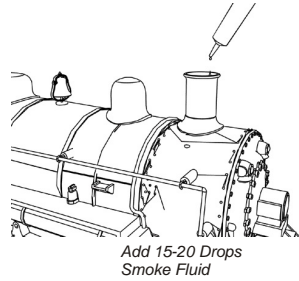

 **Running the engine without a primed smoke unit may cause damage**

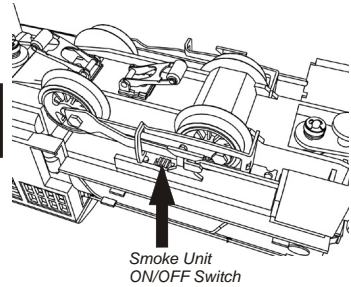

## Coupling the Engine and Cars

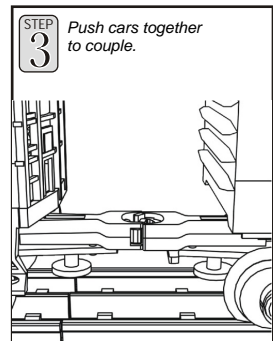
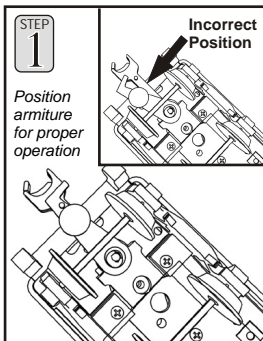

## Remote Control

The remote and lock-on are designed for use with moderate power supplies such as the one included with this set. It is compatible with virtually any manufacturer's engines.

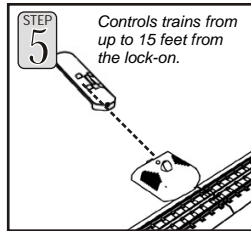
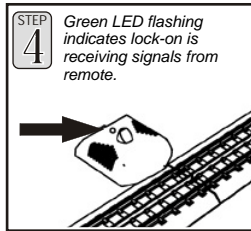
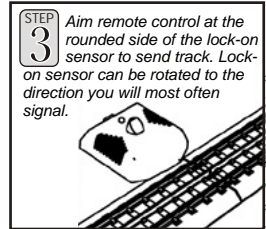
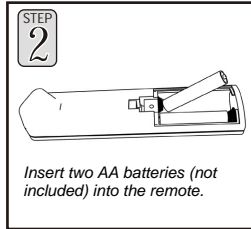
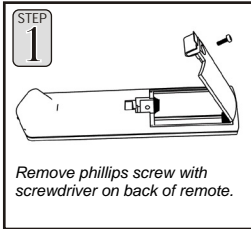

**Note:** The RailKing® Remote Control and Remote Lock-on will not operate engines equipped with pre-1997 versions of Proto-Sound® or with Proto-One,™ Proto-Plus,™ Proto-Deluxe,™ aftermarket systems.

# Basic Operation

## Operation Buttons

**Throttle Up** Throttle up the power to your track by pressing the top end of the Throttle Control Rocker Switch firmly for about 5 seconds, until the engine's headlight and lighted cars burn bright. Then put the engine into motion by firmly pressing the Direction button (hold it for approximately 1 second) on your remote once. If the engine does not begin to move as soon as you firmly press the Direction button, you may not have sent enough voltage to the track to make the train move. Press the throttle up for a few more seconds until the train begins to move.

To increase or decrease track voltage, and therefore train speed, press the throttle control rocker switch. Pressing the top end of the throttle will increase voltage and speed. Pressing the bottom end of the throttle will decrease voltage and speed.

The engine will maintain the speed you set after you release the throttle until you press it again to change the voltage and speed.

## Direction Lock

You can lock your engine into a direction (forward, neutral, or reverse) so that it will not change directions. To do this, put the engine into the direction you want, then remove the engine from the track and slide the ON/OFF switch located on the bottom of the engine to the OFF position. The engine will not change direction (including going into neutral) until you flip the switch back to ON to return the engine to its normal condition, even if the engine is kept without power for extended periods of time.

**Bell** - To sound the bell, firmly press and release the Bell button. To turn the bell off, press and release the Bell button again. The bell will continue to ring from the time you turn it on until you press and release the button again to turn it off.

**Emergency Stop** Press the Emergency Stop button and all trains on the track controlled by the remote will stop until you reapply voltage. This is an easy way to shut down your trains at the end of a session or to stop suddenly if the train's path becomes obstructed.

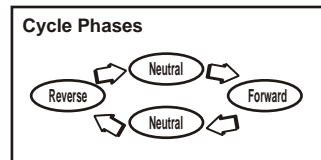
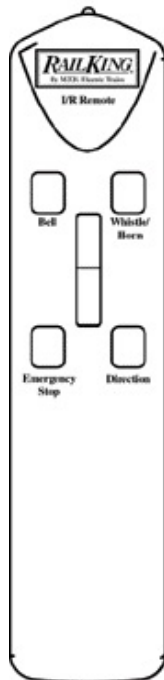

**Horn/Whistle** - To sound the whistle, firmly press the Horn/Whistle button. The whistle will sound for as long as you continue to depress the button. It will stop when you release the button.

**Direction** Your train is programmed to start in neutral. The train will always cycle neutral-forward-neutral-reverse with each press and release of the direction button. The engine is programmed to restart in neutral each time the track voltage is turned off for 25 seconds or more.

# Maintenance

## Care of the Remote Control

To ensure trouble-free operation:

- Do not drop the remote. It can damage the delicate electronics inside.
- Remove batteries before storing for extended periods.
- Any attempt by anyone other than an authorized M.T.H. Repair person to open and repair the handheld transmitter or lock-on may result in damage and the loss of warranty protection.
- If your train responds inconsistently, replace old batteries with fresh ones. Do not mix old and new batteries.



## Lubrication Instructions

The engine should be oiled and greased in order to run properly.

Regularly lubricate all side rods and linkage components and pickup rollers to prevent squeaking. Use light household oil, such as that found in M.T.H.'s maintenance kit. Do not over oil. Use only a drop or two on each pivot point.

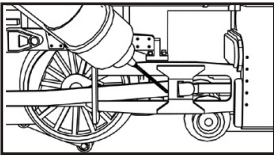

Lubricate Valve Gear

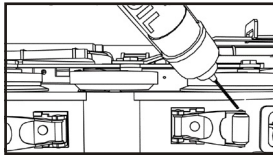

Lubricate Pick-Up Rollers  
*(Do Not Oil the Flat Part of the Pick-Up Rollers)*

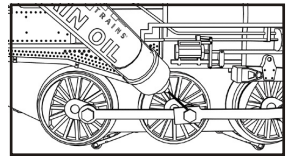

Lubricate Side Rods

## Greasing Instructions

Add grease to the internal drive gears (accessed through the gear box) annually or after every 50 hours of operation. In order to access and put grease into the gear box:

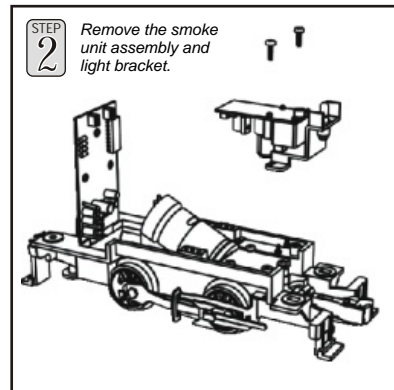
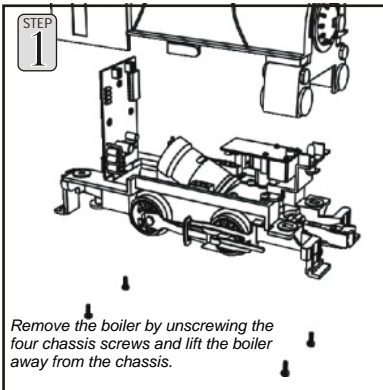



STEP  
3

Open the gear box. Unscrew the three screws on the plate located in front of the motor and lift the motor.

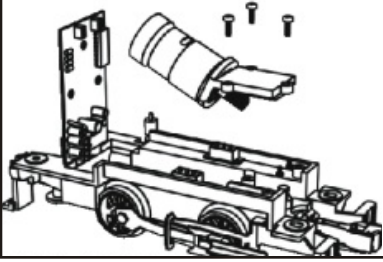

STEP  
4

Apply lithium based grease into the gear box using a grease tube dispenser such as that provided in the M.T.H. Maintenance Kit.

Reassemble in reverse order.

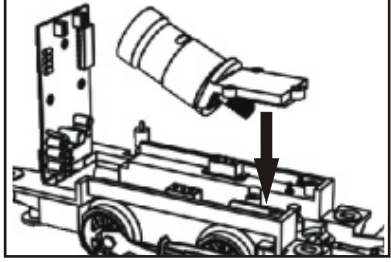

## Cleaning the Wheels, Tires and Track

Periodically check the locomotive wheels and pickups for dirt and buildup, which can cause poor electrical contact and traction. Wheels and tires can be cleaned using denatured (not rubbing) alcohol applied with a cotton swab.



To clean the track, use a clean rag and RailKing Track Cleaning Fluid or denatured (not rubbing) alcohol.

Unplug the transformer and wipe the rails of the track, turning the rag frequently to ensure that you are using clean cloth on the rails. Because the manufacturing process leaves a coating on RealTrax center rail, you should clean the rails after the first 30 minutes of use (you may notice an electrical smell during initial use as the coating wears off; this is normal). Thereafter, keep an eye on the track and clean it when it gets dirty to ensure good electrical contact and to lengthen the life of the tires.

## ProtoSmoke<sup>®</sup> Unit Operation

This steam locomotive contains a smoke unit that outputs smoke through the smokestack on the boiler of the engine. The smoke unit is essentially a small heating element and wick that soaks up and then heats a mineral oil-based fluid that emits smoke. The smoke is then forced out of the stack by a small electric fan.

With a few easy maintenance steps, you should enjoy trouble-free smoke unit operation for years.

- When preparing to run this engine, add 15-20 drops of smoke fluid through the smokestack. We recommend M.T.H. ProtoSmoke, Seuthe, LGB, or LVTs fluids (a small pipette of ProtoSmoke fluid is included). Do not overfill the unit or the fluid may leak out and coat the interior engine components.
- If you choose not to add the fluid (or have already added the fluid but choose to run smoke-free), turn off the smoke unit switch located under the engine body. **Failure either to add fluid to the unit or to**

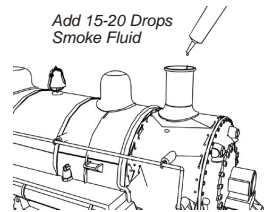

**off may damage the smoke unit heating element and/or wicking material.**

- When the smoke output while running the engine begins to diminish, add another 10-15 drops of smoke fluid or turn the smoke unit off.
- When storing the unit for long periods of time, you may want to add about 15 drops of fluid to prevent the wick from drying out.
- After removing the engine from storage, add another 25 drops of fluid, letting the wick soak up the fluid for 15 minutes prior to operation.

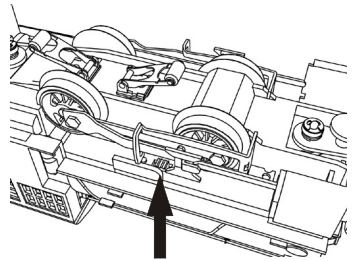

Smoke Unit ON/OFF Switch

If you experience poor or no smoke output when the smoke unit is on and has fluid, check the wick to see if it has become hard, blackened, and unabsorbent around the heating element. Remove the boiler as shown on page 7. Remove the smoke unit inspection cover from the locomotive's body (see right). After removing the chassis and inspection cover screws, lift the inspection plate away and inspect the wick. If it is darkly discolored and hard, it should be replaced. When priming new wick add 40 drops.

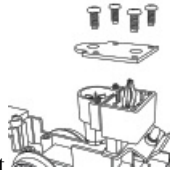

Smoke Unit Cover



Wick in Poor Condition



Wick in Good Condition

**⚠ Running the engine without a primed smoke unit may cause damage**

**Locomotive Lightbulb Replacement**

To replace the light bulb in the locomotive, follow the boiler removal instructions on page 7. (Part #CA-0000051)

Once the locomotive boiler has been removed from its chassis, locate the bulb bracket as seen in the illustration on the right and rotate the headlight bulb counter-clockwise to remove.

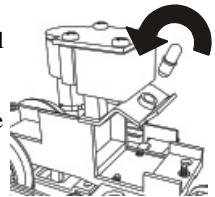

Replace Headlight Bulb

**Caboose Light Bulb Replacement**

To replace the interior light bulbs follow these instructions and see the diagrams below:

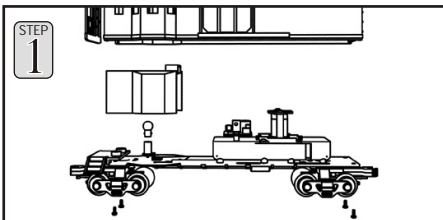

Remove the four (4) screws located under the caboose's trucks.

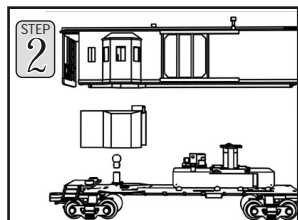

Lower the chassis from the shell, taking care not to pull the wires out.

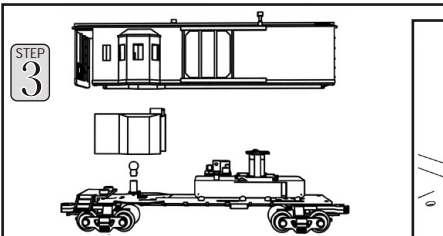

Replace a Bayonet Bulb by turning and pulling up, pulling the bulb from its socket.

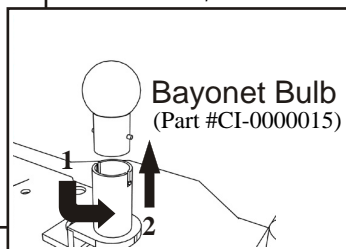

Bayonet Bulb (Part #CI-0000015)

## Quick-Start DVD

The included DVD Quick-Start video demonstrates the start-up and basic operation of this set as well as other information about model railroading. You may find it helpful to view the DVD before operating this set.

## RailWare Interactive CD ROM

M.T.H. provides a free RailWare CD ROM in each Ready-To-Run set. It is full of helpful information on M.T.H. product history, track planning software, a dealer finder, and information and video clips on Loco-Sound and Proto-Sound 2.0. Follow the directions below to use the CD ROM.

Minimum System Requirements: Pentium 100, 16MB RAM, Windows 95 or later, CD ROM drive, Sound Card, display properties set to greater than 256 colors. The CD will not work on a Mac OS unless you run VirtualPC®.

## Running RR-Track Software

You may run the RR-Track software directly off of the CD ROM or you may install the software to your hard drive.

1. On the Desktop, click on the icon that says My Computer.
2. Find your CD ROM drive.
3. With the M.T.H. CD ROM in the drive, double click on the icon for the CD ROM drive.
4. Find the folder on the CD ROM entitled INSTALLATION.
5. Choose the folder inside entitled RRTRAXSETUP.
6. Run the file in that folder called SETUP.EXE and follow the directions it provides.

The program may ask you for a registration code. If it does type in "M.T.H." and it will run.

Additional track libraries can be obtained directly from RR-Track. See their website for more information [www.rtrack.com](http://www.rtrack.com).

## Installing Adobe Acrobat Software

To read some of the electronic documents included on the CD ROM, you will need to install the Adobe Acrobat Reader® if it is not already on your computer. To install the software:

1. On the Desktop, click on the icon that says My Computer.
2. Find your CD ROM drive.
3. With the MTH CD ROM in the drive, double click on the icon for the CD ROM drive.
4. Find the folder on the CD ROM entitled INSTALLATION.
5. Choose the folder inside entitled ACROBAT READER.

\*If you are running Windows 95, 98 or NT choose the folder 32 BIT. Run the file AR32E301.EXE and follow the directions it provides.

If you have problems you cannot resolve by using these directions, contact [custserv@mth-railking.com](mailto:custserv@mth-railking.com) or call 410-381-2580 for further help.

# Troubleshooting Problems

Although this engine has been designed and engineered for ease of use, you may have some questions during initial operation. The following table should answer most questions. If your problem cannot be resolved with this table, contact M.T.H. for assistance (e-mail: [service@mth-railking.com](mailto:service@mth-railking.com); telephone: 410-381-2580; fax: 410-423-0009; mail: 7020 Columbia Gateway Drive, Columbia MD 21046-1532).

<b>Starting Up</b>	<b>Remedy</b>
When I first turn the power on, the engine will not begin to run. I have to turn the throttle off and then on again to get the engine to operate.	This is normal behavior. To prevent accidental high-speed start-ups, this engine is programmed to start up in neutral anytime track power has been turned off for several seconds. See the “Basic Operation” section for more details.
The engine will not start after I press the Direction button.	You may not be sending enough power to the track to power the engine. Press the throttle up a bit higher to increase track power.
<b>Whistle</b>	<b>Remedy</b>
I can't get the Whistle to blow when I press the whistle button.	You may be pressing the button too quickly. Try pressing the whistle button more slowly, taking approximately one full second to fully depress the button.
<b>Lock-out</b>	<b>Remedy</b>
I can't get the engine to run after I power up the transformer.	The engine may be locked into the neutral position. Follow the procedure in the “Lock into a Direction” section on page 7 to unlock the engine's direction.

# Compatibility

While this Ready-To-Run set is equipped with everything you need to operate it, the design allows flexibility. The train will operate on any traditional O-27 or larger O Gauge track system, including the RealTrax<sup>®</sup> included with this set or traditional tubular track. It is also compatible with most standard AC transformers, including the hobby transformer packaged with your set.

## Transformer Compatibility and Wiring Chart

Transformer Model	Center Rail	Outside Rail	Min/Max. Voltage	Power Rating	Transformer Type
MTH Z-500	Red Terminal	Black Terminal	0-18v	50-Watt	Electronic
MTH Z-750	Red Terminal	Black Terminal	0-21v	75-Watt	Electronic
MTH Z-1000	Red Terminal	Black Terminal	0-14v 0-18v	80-Watt 100-Watt	Electronic
MTH Z-4000	Red Terminal	Black Terminal	0-22v	390-Watt	Electronic
Lionel 1032	U	A	5-16v	90-Watt	Standard
Lionel 1032M	U	A	5-16v	90-Watt	Standard
Lionel 1033	U	A	5-16v	90-Watt	Standard
Lionel 1043	U	A	5-16v	90-Watt	Standard
Lionel 1043M	U	A	5-16v	90-Watt	Standard
Lionel 1044	U	A	5-16v	90-Watt	Standard
Lionel 1053	U	A	8-17v	60-Watt	Standard
Lionel 1063	U	A	8-17v	60-Watt	Standard
All-Trol	Left Terminal	Right Terminal	0-24v	300-Watt	Electronic
Cab-1/Power master	A	U	0-18v	135-Watt	Electronic
Dallee Hostler	Left Terminal	Right Terminal			Electronic
Lionel LW	A	U	8-18v	75-Watt	Standard
Lionel KW	A or B	U	6-20v	190-Watt	Standard
R.O.W.	Red Terminal	Black Terminal	0-24v	384-Watt	Standard
Lionel MW	Outside Track Terminal	Inside Track Terminal	5-16v	50V.A.	Electronic
Lionel RS-1	Red Terminal	Black Terminal	0-18v	50V.A.	Electronic
Lionel RW	U	A	9-19v	110-Watt	Standard
Lionel SW	U	A	Unknown	130-Watt	Standard
Lionel TW	U	A	8-18v	175-Watt	Standard
Lionel ZW	A,B,C or D	U	8-20v	275-Watt	Standard
Lionel Trailmaster	Red Terminal	Black Terminal	0-18v	135-Watt	Electronic
Lionel Post-War Celebration Series ZW	A,B,C or D	Common	0-20v	135/190 Watt	Electronic

# Dockside Engine Parts

<u>Name and Number</u>	<u>Part #</u>
1.) Shell (Alaska Cab #20)(30-4090-OE)	FB-1200327
2.) Lens ( clear ) ( headlight/reverse light )	FA-1230022
3.) Handrail ( nickel )	FB-1200103
4.) Stanchion ( black ) ( plastic )( 3.0mm long )	FB-1200242
5.) Bell ( nickel )	FB-1200101
6.) (Alaska #20)(30-4090-OE)	FB-1200328
7.) Screw ( 6/32x8.0mm )( roundhead )	IA-0000050
8.) Bolt ( nickel ) ( M3x10.0mm )( w/ 3.5x4.0mm oversized shank )	IA-0000265
9.) Bolt ( nickel ) ( M3x10.0mm )( w/ 2.0x4.0mm oversized shank )	IA-0000266
10.) Drive rod (blackened finish) ( 56.3mm long )	EC-1250033
11.) Side rod (blackened finish) ( 55.0mm long )	EC-1250034
12.) Crosshead (blackened finish)	EC-1250035
13.) Drive rod guide (blackened finish)( right )	EA-1210011
14.) Drive rod guide (blackened finish)( left )	EA-1220011
15.) Screw ( 4/40x4.0mm )( roundhead )	IA-0000021
16.) Bulb ( clear )( headlight ) ( 18v )( long bulb )( small screw base )	CA-0000051
17.) Bracket ( black )( metal ) ( for smoke unit/headlight )	IH-0000088
18.) Screw ( 4/40x6.0mm )( roundhead )	IA-0000003
19.) Smoke unit	AA-1200013
20.) Motor mount ( black )	BI-0000034
21.) Screw ( yellow Zink ) ( M2.5x6.0mm )( roundhead w/ lock washer )	IA-0000089
22.) Screw ( M2x4.0mm )( roundhead )	IA-0000058
23.) Switch ( small )	BB-0000009
24.) Drive block ( black ) ( 2 axle )( has screw holes added for part # 43 )	DF-1200035
25.) Insulator ( black ) ( top )( square )( pick-up )	BD-0000026
26.) Screw ( M3x6.0mm )( roundhead )	IA-0000015
27.) Motor ( RS-365SH ) ( 8.0x21.0mm worm gear w/ 13.0mm long threads )	BE-0000045

( 9.0x30.0mm flywheel )	
28.) Board ( reverse unit )	AC-0000007
29.) Nut ( nickel )( 2.2x6.4x2.4mm )	IC-0000010
30.) Screw ( 4/40x12.0mm )( roundhead )	IA-0000264
31.) Bracket ( Aluminum ) ( reverse unit board mounting bracket )	IH-0000089
32.) Insulator ( clear )( plastic ) ( box shaped )( 17.6x39.8x16.8mm )( 0.5mm thick )	BD-0000072
33.) T-bar ( black )( plastic )	IG-0000001
34.) Coupler	DD-0000011
35.) Armature	DD-0000012
36.) Spring ( 6.5x14.0mm )( w/ 0.5mm thick wire )	IE-0000022
37.) Washer ( plastic )( black ) ( cup shaped for spring to fit in )( 4.6x8.6x2.0mm ) ( inside 7.0x1.1mm )	ID-0000060
38.) E-clip ( 3.0x8.0x0.5mm )	IF-0000002
39.) Nut ( 2.5x5.0x7.0mm )	IC-0000008
40.) Insulator ( black ) ( pick-up )( bottom )( flat )( square )	BD-0000024
41.) Pick-up ( 8.0x11.0mm roller )( 28.0mm long )	BD-0000048
42.) Pick-up ( 8.0x11.0mm roller )( 24.0mm long )	BD-0000050
43.) Bracket ( black )( metal ) (14.0x42.7x0.5mm)(2.0x21.0mm notch on one side)	IH-0000209

# Dockside 0-4-0 Engine Parts

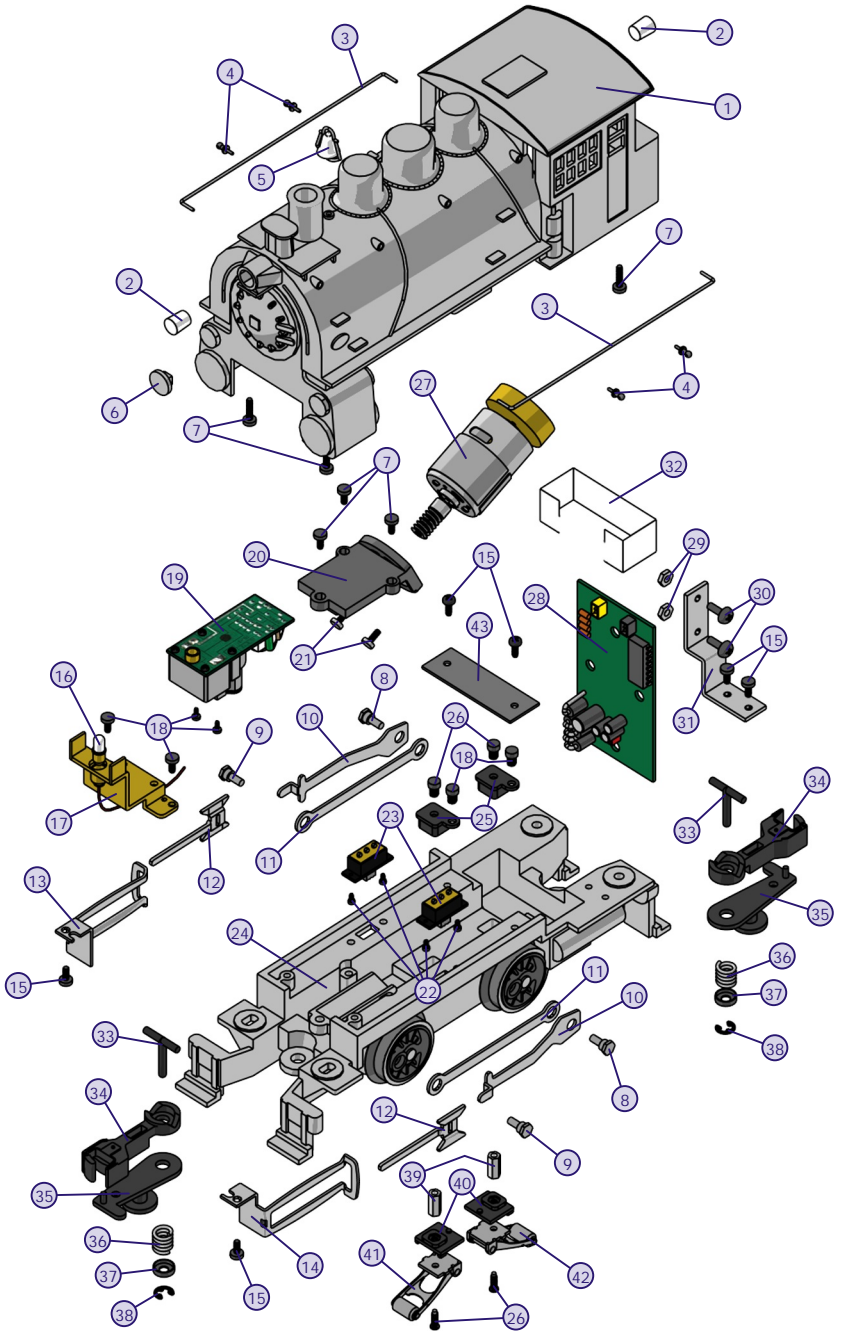



# Service & Warranty Information

## How to Get Service Under the Terms of the Limited One-Year Warranty

When you suspect an item is defective, please check the operator's manual for standard operation and trouble-shooting techniques that may correct the problem. Additional information may be found on the M.T.H. Website. Should you still require service, follow the instructions below to obtain warranty service.

First, e-mail, write, call or fax a M.T.H. Authorized Service Center (ASC) in your area to obtain Repair Authorization. You can find the list of ASCs on the M.T.H. Website, [www.mth-railking.com](http://www.mth-railking.com). Authorized Service Centers are required to make warranty repairs on items sold *only* from that store; all other repairs may-- or may not be done at the store's own discretion. If you did not purchase the item directly from the ASC, you will need to select a National Authorized Service Center (NASC). These centers are compensated by M.T.H. to perform warranty service for any customer whose repair qualifies for warranty service. A list of NASC retailers can be located on the M.T.H. Website or by calling 1-888-640-3700. Should the warranty no longer apply, you may choose either an ASC or NASC retailer to service your M.T.H. Product. A reasonable service fee will be charged.

**CAUTION:** Make sure the product is packed in its original factory packaging including its foam and plastic wrapping material to prevent damage to the merchandise. There is no need to return the entire set if only one of the components is in need of repair *unless otherwise instructed by the Service Center. **The shipment must be prepaid and we recommend that it be insured. A cover letter including your name, address, daytime phone number, e-mail address (if available), Return Authorization number (if required by the service center, a copy of your sales receipt and a full description of the problem must be included to facilitate the repairs. Please include the description regardless of whether you discussed the problem with a service technician when contacting the Service Center for your Return Authorization.***

Please make sure you have followed the instructions carefully before returning any merchandise for service. Authorized M.T.H. Service Centers are independently owned and operated and are not agents or representatives of M.T.H. Electric Trains. M.T.H. assumes no responsibility, financial or otherwise, for material left in their possession, or work done, by privately owned M.T.H. Authorized Service Centers.

If you need assistance at any time email MTH Service at [service@mth-railking.com](mailto:service@mth-railking.com), or call 410 381-2580.

## Limited One-Year Warranty

**All M.T.H. products purchased from an Authorized M.T.H. Train Merchant are covered by this warranty.**

See our website at [www.mth-railking.com](http://www.mth-railking.com) or call 1-888-640-3700 to identify an Authorized M.T.H. Train Merchant near you.

M.T.H. products are warranted for one year from the date of purchase against defects in material or workmanship, excluding wear items such as light bulbs, pick-up rollers, batteries, smoke unit wicks, and traction tires. We will repair or replace (at our option) the defective part without charge for the parts or labor, if the item is returned to the M.T.H. Authorized Service Center (ASC) where it was purchased or a M.T.H. National Authorized Service Center (NASC) within one year of the original date of purchase. This warranty does not cover damages caused by improper care, handling, or use. Transportation costs incurred by the customer are not covered under this warranty.

Items sent for repair must be accompanied by a return authorization number, a description of the problem, and a **copy of the original sales receipt from an Authorized M.T.H. Train Merchant**, which gives the date of purchase. If you are sending this product to an Authorized Service Center, contact that Center for their return authorization.

This warranty gives you specific legal rights, and you may have other rights that vary from state to state. Specific questions regarding the warranty may be forwarded to M.T.H. directly.

Service Department  
M.T.H. Electric Trains  
7020 Columbia Gateway Drive  
.Columbia MD 21046-1532



# AUTHORIZED SERVICE CENTER

7020 Columbia Gateway Dr. - Columbia, MD 21046

Information: 410-381-2580 Fax: 410-381-6122

[www.mth-railking.com](http://www.mth-railking.com)

## PARTICIPATING A.S.C. RETAILER LIST

### ALABAMA

SOUTHERLAND STATION  
HUNTSVILLE  
256-533-4720

### ARIZONA

ARIZONA TRAIN DEPOT  
MESA  
480-833-9486

### CALIFORNIA

CENTRAL COAST TRAINS  
ATASCADERO  
805-466-1391

TRAIN SHACK  
BURBANK  
818-842-3330

REED'S HOBBY SHOP  
LA MESA  
619-464-1672

ROUNDHOUSE  
NORTH HOLLYWOOD  
818-769-0403

DOLLHOUSES, TRAINS &  
MORE  
NOVATO  
415-883-0388

TIN PLATE JUNCTION  
OAKLAND  
510-444-4780

RON'S WORLD  
SAN CLEMENTE  
949-361-5596

BLACK NIGHT TRAINS &  
HOBBIES  
SANTA ROSA  
707-523-3522

### COLORADO

CUSTOM RAILWAY SUPPLY  
COLORADO SPRINGS  
719-634-4616

CABOOSE HOBBIES, INC.  
DENVER  
303-777-6766

MIZELL TRAINS  
WESTMINSTER  
303-429-4811

### CONNECTICUT

TIME MACHINE HOBBY, LL C  
MANCHESTER  
860-646-0610

### FLORIDA

AMHERST DEPOT  
ENGLEWOOD  
941-475-2020

DEPOT HOBBY SHOP  
IANTANA  
561-585-1982

HOLLYWOOD STATION  
MIAMI  
954-921-2700

READY TO ROLL  
MIAMI  
305-688-8868

COLONIAL PHOTO & HOBBY  
ORLANDO  
407-841-1485

WARRICK CUSTOM HOBBIES  
PLANTATION  
954-370-0708

ROUNDHOUSE SOUTH  
PORT ORANGE  
386-304-7002

### ILLINOIS

BERWYN'S TOY TRAINS &  
MODELS  
BERWYN  
708-484-4384

CHICAGOLAND HOBBY  
CHICAGO  
773-775-4848

BILL'S ENGLEWOOD STATION  
ORLAND PARK  
708-460-4906

BIKE & CHOO CHOO  
CONNECTION  
SCHAUMBURG  
847-882-7728

### INDIANA

Y. O. R. K. TRAINS  
MUNSTER  
219-838-9999

SAMUELSON'S TRAIN SHOP  
VALPARAISO  
219-462-2708

### IOWA

CABOOSE STOP HOBBIES  
CEDAR FALLS  
800-642-7012

### KANSAS

HOBBY HAVEN  
OVERLAND PARK  
913-381-3111

### KENTUCKY

L & N TRAINS & THINGS  
LOUISVILLE  
502-897-9005

**LOUISIANA**

AMERICA'S TRAIN YARD  
BATON ROUGE  
225-926-5592

**MAINE**

WHEELS, WINGS & THINGS  
LUDLOW  
207-532-6277

**MARYLAND**

HOBBYTOWN U S A  
FREDERICK  
301-694-7395

FREDERICK JUNCTION  
FREDERICK  
301-694-3434

ENGINE HOUSE HOBBIES  
GAITHERSBURG  
301-590-0816

J & B TRAINS  
HAGERSTOWN  
240-420-4930

THE TRAIN ROOM  
HAGERSTOWN  
301-745-6681

PURKEY'S TOY TRAINS  
SYKESVILLE  
410-549-6061

CATOCTIN MOUNTAIN TRAINS  
& HOBBIES  
THURMONT  
301-694-8331

E.L. JONES & SONS  
WILLIAMSPORT  
800-810-8138

**MASSACHUSETTS**

FLYING YANKEE HOBBY  
SHOP  
BOSTON  
617-323-9702

NORTHEAST TRAINS  
PEABODY  
978-532-1615

EAST BAY HOBBIES  
SEEKONK  
508-336-5573

PIONEER VALLEY HOBBIES  
W. SPRINGFIELD  
413-732-5531

**MICHIGAN**

MICHIGAN MODEL TRAIN  
CENTER  
PINCKNEY  
734-426-1651

BRASSEUR ELECTRIC  
TRAINS INC.  
SAGINAW  
989-793-4753

**MINNESOTA**

DON'S HOBBY CO.  
MANKATO  
507-387-1330

**MISSOURI**

SWITCH STAND  
SAINT LOUIS  
314-781-4458

MARK TWAIN HOBBY CENTER  
ST. CHARLES  
636-946-2816

**NEVADA**

RENO RAILS  
RENO  
775-337-6669

**NEW HAMPSHIRE**

TREASURED TOYS  
SALEM  
603-898-7224

**NEW JERSEY**

HOBBY SHOP  
ABERDEEN  
732-583-0505

COUNTRY AND STUFF  
ANDOVER  
973-786-7086

GENE'S TRAINS  
BRICK  
732-840-9728

COLUMBUS TRAIN STATION  
COLUMBUS  
609-518-1800

ATLANTIC RAILS  
HAMMONTON  
609-567-8490

C B TRAIN DEPOT  
HILLSDALE  
201-666-9598

GRAND CENTRAL STATION  
KEARNY  
201-955-6200

J & B TRAINS, INC.  
MAPLE SHADE  
856-414-0092

HOBBYMASTERS, INC  
RED BANK  
732-842-6020

RIDGEFIELD HOBBY  
RIDGEFIELD  
201-943-2636

TOM'S MODEL TRAINS  
SCOTCH PLAINS  
908-322-6122

TRAINS & THINGS  
TRENTON  
609-883-8790

HOLLY BEACH TRAIN DEPOT  
WILDWOOD  
609-522-2379

**NEW YORK**

L B C MODEL TRAINS  
BUFFALO  
716-631-3081

KURT'S TRAINS & HOBBIES  
CALEDONIA  
585-538-2960

AURORA RAILS & HOBBIES  
EAST AURORA  
716-652-5718

NASSAU HOBBY CENTER,  
INC.  
FREEPORT  
516-378-9594

J & R JUNCTION  
LIVERPOOL  
315-451-6551

HOBBY WORLD  
MONTICELLO  
845-794-8770

CITY DEPOT, INC.  
NEW HAMPTON  
845-374-3010

THIRD STREET DEPOT  
NIAGARA FALLS  
716-285-6464

ISLAND TRAINS  
STATEN ISLAND  
718-317-0008

SCAG'S ELECTRIC TRAIN  
SHOP  
STATEN ISLAND  
718-727-7373

AMERICANA STORE  
TIVOLI  
845-757-4246

KROSS HARDWARE  
WEST BABYLON  
631-669-3069

WESTCHESTER CENTRAL  
TRAINS  
WHITE PLAINS  
914-421-1262

**NORTH CAROLINA**

THE ROUNDHOUSE &  
BACKSHOP  
CARY  
919-465-0810

DRY BRIDGE STATION  
MOUNT AIRY  
336-786-9811

THE FREIGHT YARD  
SMITHFIELD  
919-934-6229

LITTLE CHOO CHOO SHOP  
INC.  
SPENCER  
704-637-8717

TRAIN LOFT  
WINSTON-SALEM  
336-760-9817

**OHIO**  
E & S TRAINS  
AKRON  
330-745-0785

T & K HOBBY SHOP  
BRIDGEPORT  
740-633-6607

PARMA HOBBY  
CLEVELAND  
216-741-6440

SANDY'S HOBBY'S &  
COLLECTIBLES  
ELYRIA  
440-365-9999

DUNHAM'S TOY TRAINS  
LONDON  
740-852-0899

CLEARVIEW TRAIN & HOBBY  
LORAIN  
440-277-4488

DIXIE UNION STATION  
MASON  
513-459-0460

DAVIS TRAINS  
MILFORD  
1-800-448-1060

ERIE RAILWAY DEPOT  
TROY  
937-440-9922

**PENNSYLVANIA**  
AMERICAN HOBBY CENTER  
ALQUIPPA  
724-378-3930  
BUSSINGER TRAINS  
AMBLER  
215-628-2366

JIM'S HOBBY SERVICE  
BERWICK  
570-759-2695

YE OLDE TRAIN &  
CHRISTMAS SHOPPE  
BOYERTOWN  
610-369-0755

NICHOLAS SMITH TRAINS  
BROOMALL  
610-353-8585

CHARLEROI SWEEPER  
CENTER  
CHARLEROI  
724-483-3397

JERRY QUINN TRAINS & TOYS  
COATESVILLE  
610-383-1931

CRANBERRY HOBBY DEPOT  
CRANBERRY TWP  
724-776-3640

FAIRCHANCE PHARMACY  
FAIRCHANCE  
724-564-7817

TRAINS R FUN  
FRAZER  
610-644-4585

THE CABOOSE  
LEHIGHTON  
570-386-5352

SCHUYLKILL FLYER HOBBIES  
LEESPORT  
484-248-2100

HOBBY CITY  
McMURRAY  
724-942-2557

ENGLISH MODEL RR  
MONTOURSVILLE  
800-327-5126

STATION/M H INDUSTRIES  
NEW CUMBERLAND  
717-774-7096

FRYER'S STORE  
ORWIGSBURG  
570-366-2258

TOBY TYLER'S HOBBY  
CENTER  
PITTSBURGH  
412-653-5030

WILCOX GREENHOUSE &  
NURSERY  
TITUSVILLE  
814-827-3823

EASTERN DEPOT  
TROY  
570-297-1975

J & J RAILROAD CROSSING  
INC  
TURTLE CREEK  
412-824-6009

THE TRAIN SHOPPE & HOBBY  
CENTER LD  
WILKES BARRE  
570-824-7688

**RHODE ISLAND**  
GRANDMA'S HOUSE  
GRANDPA'S TRAIN  
WARWICK  
401-463-7803

**SOUTH CAROLINA**  
EMERALD TRAIN & HOBBY  
GREENWOOD  
864-223-2247

**TENNESSEE**  
MODEL RAILROAD & HOBBY  
SHOP  
MEMPHIS  
901-384-6500

TRAINS-N-THINGS  
PARIS  
731-641-8880

**TEXAS**  
HOBBY TIME  
AMARILLO  
806.352.9660

RIVERVIEW TRAINS  
ANGLETON  
979-848-3895

GREAT TRAINS & HOBBIES  
LONGVIEW  
903-757-2720

**UTAH**  
ALMOSTA JUNCTION  
CLEARFIELD  
801-776-1656

**VIRGINIA**  
LEESBURG HOBBIES &  
COLLECTIBLES  
LEESBURG  
703-779-8600

LOCUST GROVE TRAINS  
LOCUST GROVE  
540-854-8955

TRAINS, ETC.  
LORTON  
703-550-1779

TRAIN DEPOT  
MANASSAS  
703-335-2216

CHESTERFIELD HOBBIES  
MIDLOTHIAN  
804-379-9091

DAVIS HOBBY SUPPLIES  
PORTSMOUTH  
757-397-1983

TOY TRAIN CENTER  
RICHMOND  
804-288-4475

T S G HOBBIES  
WARRENTON  
540-347-9212

NORGE STATION  
WILLIAMSBURG  
757-564-7623

**WASHINGTON**  
EASTSIDE TRAINS  
KIRKLAND  
425-828-4098

**WEST VIRGINIA**  
PATRICK'S TRAINS  
WHEELING  
304-232-0714

**WISCONSIN**  
WOODCRAFTERS SHOP  
BURLINGTON  
262-763-5239

SOMMERFELD'S TRAINS  
BUTLER  
262-783-7797  
HOBBY OUTLET  
FOND DU LAC  
920-924-3770

G B T V & TRAINS  
GREEN BAY  
920-496-9697

GRAMPA'S TRAIN SHOP  
RICE LAKE  
715-234-2996

**CANADA**  
TOY TRAIN WORKSHOP  
CUMBERLAND  
613-833-8331

THE TRAIN ROOM  
FERGUS  
19-787-3280

CREDIT VALLEY RAILWAY  
COMPANY  
TREETSVILLE  
905-826-1306

B&H TRAINS  
TERREBONNE  
514-793-9696

## **PARTICIPATING N.A.S.C. LIST**

**CALIFORNIA**  
TIN PLATE JUNCTION  
OAKLAND  
510-444-4780

**COLORADO**  
MIZELL TRAINS  
WESTMINSTER  
303-429-4811

**CONNECTICUT**  
TIME MACHINE HOBBY, LL C  
MANCHESTER  
860-646-0610

**FLORIDA**  
COLONIAL PHOTO & HOBBY  
ORLANDO  
407-841-1485

ROUNDHOUSE SOUTH  
PORT ORANGE  
386-304-7002

**ILLINOIS**  
CHICAGOLAND HOBBY  
CHICAGO  
773-775-4848

**KENTUCKY**  
L&N TRAINS & THINGS  
LOUISVILLE  
502-897-9005

**MARYLAND**  
ENGINE HOUSE HOBBIES  
GAITHERSBURG  
301-590-0816

CATOCTIN MOUNTAIN TRAINS  
& HOBBIES  
THURMONT  
301-694-8331

**MICHIGAN**  
MICHIGAN MODEL TRAINS  
PINCKNEY  
734-426-1651

BRASSEUR ELEC. TRAINS  
SAGINAW  
989-793-4753

**NEW HAMPSHIRE**  
TREASURED TOYS  
SALEM  
603-898-7224

**NEW YORK**  
L B C MODEL TRAINS  
BUFFALO  
716-631-3081

AURORA RAILS & HOBBIES  
EAST AURORA  
716-652-5718

THIRD STREET DEPOT  
NIAGARA FALLS  
716-285-6464

**OHIO**  
DAVIS TRAINS  
MILFORD  
1-800-448-1060

**PENNSYLVANIA**  
BUSSINGER TRAINS  
AMBLER  
215-628-2366

JIM'S HOBBY SERVICE  
BERWICK  
570-759-2695

FAIRCHANCE PHARMACY  
FAIRCHANCE  
724-564-7817

ENGLISH MODEL RR  
MONTOURSVILLE  
800-327-5126

TOBY TYLER'S HOBBY CEN.  
PITTSBURGH  
412-653-5030

**VIRGINIA**  
LOCUST GROVE TRAINS  
LOCUST GROVE  
540-854-8955

DAVIS HOBBY SUPPLIES  
PORTSMOUTH  
757-397-1983

T S G HOBBIES  
WARRENTON  
540-347-9212

**WISCONSIN**  
SOMMERFELD'S TRAINS  
BUTLER  
262-783-7797

GRAMPA'S TRAIN SHOP  
RICE LAKE  
715-234-2996

**CANADA**  
TOY TRAIN WORKSHOP  
CUMBERLAND  
13-833-8331

THE TRAIN ROOM  
FERGUS  
519-787-3280